

26TH International Conference on Health Promoting Hospitals and Health Services

Program

June 6-8, 2018 – Bologna, Italy



Health promotion strategies to achieve reorientation of health services: evidence-based policies and practices



International Network of
Health
Promoting
Hospitals & Health Services



Gesundheit Österreich
GmbH
WHO Collaborating Centre
for Health Promotion
in Hospitals and Health Care

Regione Emilia-Romagna

Local Organizer



SERVIZIO SANITARIO REGIONALE
EMILIA-ROMAGNA
Azienda Unità Sanitaria Locale di Reggio Emilia
IRCCS Istituto in tecnologie avanzate e modelli assistenziali in oncologia

Under the auspices of



COMUNE DI BOLOGNA

ISTITUTO
SUPERIORE
DI SANITÀ



Ministero della Salute



ALMA MATER STUDIORUM
UNIVERSITÀ DI BOLOGNA



UNIMORE
UNIVERSITÀ DEGLI STUDI DI
MODENA E REGGIO EMILIA



UNIVERSITÀ
DI PARMA



Università
degli Studi
di Ferrara

TABLE OF CONTENT

General Information	4
Location	7
Program Overview – Satellite Events	10
Monday, June 4, 2018	10
Tuesday, June 5, 2018	10
Wednesday, June 6, 2018	10
Program Overview – Main Conference	12
Wednesday, June 6, 2018	12
Thursday, June 7, 2018	12
Friday, June 8, 2018	13
Program Details – Main Conference	16
Wednesday, June 6, 2018	16
Plenary Session	16
Thursday, June 7, 2018	17
Plenary Sessions	17
Oral Sessions	18
Mini Oral Sessions	26
Poster Sessions	32
Friday, June 8, 2018	51
Plenary Sessions	51
Oral Sessions	52
Mini Oral Sessions	61
Poster Sessions	66
Maps of Conference Venue	86
Notes	89

GENERAL INFORMATION

Venue Addresses

Main Conference

Palazzo della cultura e dei congressi
Piazza Costituzione, 4/a
40128 Bologna, Italy

HPH Newcomers Workshop

Tuesday June 5, 2018 14.00-17.00

Region Emilia-Romagna
Room B, Terza Torre
Viale della Fiera, 8
40128 Bologna, Italy

HPH Summer School

(Day 1) Monday, June 4, 2018 13.00-17.00

Regional Health and Social Agency
Room 216 C, 2^a floor
Viale Aldo Moro, 21
40128 Bologna, Italy

(Day 2) Tuesday, June 5, 2018 9.00-14.00

Region Emilia-Romagna
Room B, Terza Torre
Viale della Fiera, 8
40128 Bologna, Italy

Conference Hours

Monday, June 4, 2018 13:00-17:00

Tuesday, June 5, 2018 09:00-14:00
14:00-17:00

Wednesday, June 6, 2018 from 08:30
09:00-16:00
17:00-17:45
17:45-19:00
from 19:00

Thursday, June 7, 2018 from 08:30
09:00-17:45
from 19:00

Friday, June 8, 2018 from 08:30
09:00-17:45
17:45-18:30

HPH Summer School (Day 1)

HPH Summer School (Day 2)

HPH Newcomers Workshop

Registration

Pre-Conference Program

Formal Opening

Scientific Program

Welcome Reception

Registration

Scientific Program

Conference Dinner

Registration

Scientific Program

Farewell Refreshments

Badge

All participants and accompanying persons are kindly asked to wear the name badges in the conference area at all times.

GENERAL INFORMATION

Language

English. No simultaneous translation provided.

Certificate of Attendance

All participants will receive a certificate of attendance.

Entitlements

Participants are admitted to the whole scientific program, coffee breaks and lunch, welcome reception and farewell refreshments and, if they have registered and paid for it, the conference dinner. Accompanying persons are admitted to the welcome reception, the conference dinner and the farewell refreshments. No admission to the scientific program is granted.

No Smoking Policy

Smoking is strictly prohibited anywhere at the conference venue.

Posters

Posters are on display throughout the conference.

Posters from P1 to P229 should be set up until Thursday, June 7, 12:00 and removed at the latest until Friday 8:30.

Posters from P230 to P453 should be set up on Friday, June 8, until 10:30 and removed at the latest until Friday, 19:00.

Equipment for mounting the posters will be provided by the conference organizers. The conference takes no responsibility for left or damaged posters.

Main Conference Venue

Bologna Congress Center is located just a few minutes from the city center, the railway station and Bologna Airport; it is also served by a dedicated exit of the A1 motorway and is equipped with ample parking facilities.

Conference Dinner

The conference dinner will take place at Bologna Congress Center Thursday June 7 at 19.30

Note: the dinner has an admission fee (€ 80).

During the conference dinner the award will be presented:

The 2017 HPH Award for Best Fulfilment of the HPH Standards

GENERAL INFORMATION

WiFi (Network key + browser user e password)

Connect to **BcWiFi** network choosing it from the list of available networks, and type the following password : **bocowifi**

Open the browser, you will be asked username and password; please type the following:

Username**hphbologna**.....

Password**bologna2018**.....

The network card of the device has to be set in DHCP and not in proxy.

SMTP server has to be the user's server with username and password.

It is possible to create a VPN with a client chosen by the user.

It is possible to use email programs, chat (es: Outlook, Skype, MSN, Facebook etc.).

IT IS NOT POSSIBLE to post on the web (PC, Cameras etc.).

Please keep Windows firewall running.

All the set-ups necessary to make the device connect to the Bologna Congressi WiFi network is at user's care. Bologna Congressi is not responsible for possible connection problems caused by set-ups and features of the user's device.

Please note that most of devices in stand-by mode turn off the network card , causing the disconnection from the wifi. The device will automatically reconnect when it is turned on. We recommend to turn off the "automatic standby mode"while you are in the venue.



Anyway, username and password will be required again after a 12 hours standby.

- Android devices: you might avoid disconnection by disabling "off when unplugged" and "off when screen off" options (in the sample picture they are checked, they must be unchecked).
- IOS devices: in many models it is impossible to avoid standby mode activation, if the device is not plugged to electricity.

LOCATION

Welcome to Bologna

Bologna is the capital and largest city of the Emilia-Romagna Region in Northern Italy, at the heart of a metropolitan area of about one million people. Bologna enjoys a privileged geographical position at a natural crossroads within both Italy and Europe.

Of Etruscan origin, the city has been a major urban centre for centuries. Home to the oldest university in the world, the University of Bologna, established in AD 1088, the city has a large student population that gives it a cosmopolitan character. In 2000, it was declared European capital of culture and in 2006, a UNESCO “city of music”.

Famous for its towers, churches and lengthy porticoes, today Bologna is a major industrial and commercial centre, the most important rail and motorway hub in the country, and after Venice the city with the best preserved old town centre in Italy. At the same time, it is surrounded by modern buildings, state-of-the-art exhibition, conference centres and new residential districts.

Tortellini, tagliatelle, lasagne and mortadella are just a few of the culinary delights that have made the city world famous for its gastronomic tradition and have earned it the epithet “Bologna the Fat”.

For accompanying persons including children, Bologna offers numerous museums and tourist attractions.

Weather

Bologna in June experiences pleasant and warm days with slightly cloudy sky and, now and then, the chance of some rain. Typically, temperature fluctuates around 22°C.

Shopping

Opening times on weekdays are 9:00 to 19.30, some until 20:00. All shops, with very few exceptions, remain closed on Sundays.

Currency and Credit Cards

The Italian currency is the EURO (€). Most hotels, restaurants and shops accept internationally valid credit cards.

Electricity

The current electricity used in Italy is 220 V, with 50 Hz frequency.

Public Transport

Bologna is a city on a human scale and in the historical center many distances can be fast covered on foot. An efficient public transport system allows to go quickly anywhere in the city. Visitors arriving at Guglielmo Marconi International Airport can reach the Central Station and the city center in a few minutes by the Aerobus – BLQ line. Different car rental services with driver and an efficient taxi service are available for visitors 24 hours a day.



Fountain of Neptune

PROGRAM OVERVIEW

Satellite Events



Saint Petronio statue between the Two Towers

PROGRAM OVERVIEW

Satellite Events

MONDAY, JUNE 4, 2018

- 13:00–17:00 **HPH Summer School**
Implementation models and frameworks: How to disseminate and implement new evidence in healthcare
Day 1
Venue: Regional Health and Social Agency - Room 216 C, 2nd floor
-

TUESDAY, JUNE 5, 2018

- 09:00–14:00 **HPH Summer School**
Implementation models and frameworks: How to disseminate and implement new evidence in healthcare
Day 2
Venue: Region Emilia-Romagna Room B, Terza Torre
-

- 14:00–17:00 **HPH Newcomers Workshop**
Venue: Region Emilia-Romagna Room B, Terza Torre
-

WEDNESDAY, JUNE 6, 2018

- 09:00–16:00 **HPH General Assembly (upon invitation only)**
Venue: Sala Maggiore, Room Sala Magenta A
-

- 09:00–16:00 **Pre-Conference**
by the Global Network for Tobacco Free Health Care Services (GNTH):
Tobacco free standards achieving change in healthcare services:
Sharing evidence-based policies and practices
Venue: Palazzo della cultura e dei congressi, Foyer Italia
-

PROGRAM OVERVIEW

Main Conference



Bologna city centre

PROGRAM OVERVIEW

Main Conference

Wednesday, June 6, 2018

- 17:00-17:45 **Formal Opening**
Venue: Palazzo della cultura e dei congressi, Europa Auditorium
-
- 17:45-19:00 **Plenary 1**
Good governance for health promoting health services
Venue: Palazzo della cultura e dei congressi, Europa Auditorium
-
- 19:00-21:00 **Welcome Reception**
Venue: Sala Maggiore, Foyer - first floor
-

Thursday, June 7, 2018

- 09:00-10:30 **Plenary 2**
The role of HPH in developing people-centered health care systems by coordinated and integrated health care services
Venue: Palazzo della cultura e dei congressi, Europa Auditorium
-
- 10:30-11:00 **Coffee, tea, refreshments**
Venue: Sala Maggiore, Foyer - first floor
-
- 11:00-12:30 **Oral sessions 1**
Venue: see detailed information in the following pages
-
- 12:30-13:30 **Lunch**
Venue: Sala Maggiore, Foyer - first floor
-
- 13:30-14:15 **Mini oral sessions 1**
Venue: see detailed information in the following pages
-
- 13:30-14:15 **Poster presentations 1**
Venue: Sala Maggiore, second floor
-
- 14:15-15:45 **Oral sessions 2**
Venue: see detailed information in the following pages
-
- 15:45-16:15 **Coffee, tea, refreshments**
Venue: Sala Maggiore, Foyer - first floor
-

PROGRAM OVERVIEW

Main Conference

16:15-17:45 **Plenary 3**
Incorporating health promotion in disease management programs for NCDs
Venue: Palazzo della cultura e dei congressi, Europa Auditorium

19:30-22:00 **Conference Dinner**
Venue: Sala Maggiore, Foyer - first floor

Friday, June 8, 2018

09:00-10:30 **Plenary 4**
Co-producing better health gain by user participation and community involvement
Venue: Palazzo della cultura e dei congressi, Europa Auditorium

10:30-11:00 **Coffee, tea, refreshments**
Venue: Sala Maggiore, Foyer - first floor

11:00-12:30 **Oral sessions 3**
Venues: see detailed information in the following pages

12:30-13:30 **Lunch**
Venue: Sala Maggiore, Foyer - first floor

13:30-15:00 **Plenary 5**
Strengthening health promotion and disease prevention in primary health services
Venue: Palazzo della cultura e dei congressi, Europa Auditorium

15:00-15:30 **Coffee, tea, refreshments**
Venue: Sala Maggiore, Foyer - first floor

15:30-16:15 **Mini oral sessions 2**
Venue: see detailed information in the following pages

15:30-16:15 **Poster presentations 2**
Venue: Sala Maggiore, second floor

16:15-17:45 **Oral sessions 4**
Venue: see detailed information in the following pages

17:45-18:30 **Farewell refreshments**
Venue: Foyer Europa



Saint Petronio basilica

PROGRAM DETAILS

Main Conference



Fountain of Neptune and D'Accursio Palace

PROGRAM DETAILS

WEDNESDAY, June 6, 2018

17:00-17:45 Formal Opening

Venue: Sala Europa

Chair: Antonio CHIARENZA, Coordinator, HPH Network Emilia-Romagna (ITA),

Welcome addresses by:

Giuliano BARIGAZZI, Health and Welfare Policy Assessor, Municipality of Bologna (ITA)

Mirko DEGLI ESPOSTI, Deputy Vice Chancellor, Alma Mater Studiorum University of Bologna (ITA)

Sergio VENTURI, Health Policy Assessor, Emilia-Romagna Region (ITA)

Stefano BONACCINI, President of the Government of Emilia-Romagna Region (ITA)

Anna CICHOWSKA MYRUP, Division of Health Systems and Public Health WHO Regional Office for Europe

Bożena WALEWSKA-ZIELECKA, Former Chair of HPH Governance Board, Coordinator HPH Network Poland (POL) and the Newly Elected Chair of HPH Governance Board

Jürgen M. PELIKAN, Director, WHO Collaborating Centre for Health Promotion in Hospitals and Health Care (AUT)

17:45-19:00 Plenary 1

Good governance for health promoting health services

Venue: Palazzo della cultura e dei congressi, Europa Auditorium

Chairs: Christina DIETSCHER (AUT), Carlo FAVARETTI (ITA)

The global perspective on good governance for health promoting health services

Representative of WHO Regional Office for Europe

Large system transformation to facilitate people-centered health care systems

Alex BERLAND, In-Source Research Group, Vancouver (CAN)

Effective policies and strategies to implement health promotion

Walter RICCIARDI, President of the Italian National Institute of Health (Istituto Superiore di Sanità)

Effective policies and strategies to implement health promotion: the Emilia-Romagna case

Kyriacoula PETROPULACOS, Director of the Regional Health and Welfare Department of Emilia-Romagna Region (ITA)

Is HPH contributing to improving governance for health promoting hospitals and health services?

Sally FAWKES, Coordinator, Australian HPH Network, Melbourne (AUS)

19:00-21:00 Welcome Reception

Venue: Sala Maggiore, Foyer - first floor

PROGRAM DETAILS

THURSDAY, June 7, 2018

09:00-10:30 Plenary 2

The role of HPH in developing people-centered health care systems by coordinated and integrated health care services

Venue: Palazzo della cultura e dei congressi, Europa Auditorium

Chairs: Margareta KRISTENSON (SWE), Maria Luisa MORO (ITA)

Health promoting hospitals and health services as main drivers for more people-centered health systems

Susan B. FRAMPTON, President, Planetree, Derby (USA)

Deployment of integrated care services for complex chronic patients. Limitations and opportunities

Carmen HERNÁNDEZ, Coordinator Integrated Care Unit, Medical and Nursing Direction, Hospital Clinic, Barcelona (ESP)

Towards older people-centered health care in a global aging era - Taiwan's framework of age-friendly health care

Shu-Ti CHIOU, Coordinator, HPH Taskforce on Age-friendly Health Care, Taipei (TWN)

Standards and indicators on health promotion: re-orienting healthcare services for children's health promotion

Ilaria SIMONELLI, Coordinator, HPH Taskforce for Health Promotion with children and adolescents, Bologna (ITA)

16:15-17:45 Plenary 3

Incorporating health promotion in disease management programs for NCDs

Venue: Palazzo della cultura e dei congressi, Europa Auditorium

Chairs: Hanne TØNNESEN (DNK), Roberto GRILLI (ITA)

Value-based health care - implications for tackling dementia, disability and dependence

Erica ISON, Better Value Healthcare Ltd (GBR)

Examples and contributions of HPH to mental health promotion and mental illness prevention

Lise-Lotte RISÖ BERGERLIND, Coordinator, HPH Mental Health Task Force, Västra Götalandsregionen (SWE)

Evidence-based policies and practices for health promotion in disease management programs for NCDs

Raffaele ZORATTI, Former Chair of the HPH Governance Board, Ospedale Santa Maria della Misericordia, Udine (ITA)

Examples and contributions of the Taiwanese HPH Network to improve primary and secondary prevention of NCDs

Ying-Wei WANG, Coordinator of the Taiwanese HPH Network and Director General, Health Promotion Administration, Ministry of Health and Welfare, Taipei (TWN)

PROGRAM DETAILS

THURSDAY, June 7, 2018

11:00-12:30 Oral sessions 1

O1.1 Reorienting health services

Venue: Sala Maggiore, Celeste Room

Chair: Bożena WALEWSKA-ZIELECKA (POL)

Core values - A strategy to achieve person-centered care

Yvonne A. JOHANSSON, Elisabeth KENNE SARENMALM, Inger BÖL (SWE)

Collaborative methodology in Stakeholder and Change Management

N. RODRÍGUEZ VALIENTE, M. MOHARRA FRANCES, T. SALAS FERNÁNDEZ, H. SCHONENBERG, V. GAVEIKAITE, R. v. d. HEIJDEN, D. FILOS, K. LOURIDA, I. CHOUVARDA, N. MAGLAVERAS, S. NEWMAN, J. ROCA, J. ESCARRABILL, C. BUCHNER, S. HUN, E. RITSON, C. PEDERSEN, E. NIELSEN, M. CRAGGS, D. BARRETT, J. HATFIELD, A. FULLAONDO, D. SCHEPIS, E. DE MANUEL, E. BUSKENS, M. LAHR, I. ZABALA, S. STÖRK (ESP)

Empowering Hospital: an effectiveness trial of a health promotion model in the hospital setting

Alessandro COPPO, Fabrizio FAGGIANO, Angelo PENNA, Maurizio BACCHI, Lucas DONAT (ITA)

Diversity policy inside a psychiatric hospital - good practices

Esther VAN REETH, Ria DHAEZE, Sofie VAN De GEUCHTE, Leona VAN VAERENBERGH (BEL)

Implementation of a new national health promotion framework in a university teaching hospital in the Republic of Ireland

Elaine CUNNIFFE, Sinead STYNES, Ailsa LYONS, Kirsten DOHERTY, Laura KINSELLA, Leslie DALY, Cecily KELLEHER, Patricia FITZPATRICK (IRE)

O1.2 Healthy nutrition

Venue: Palazzo della cultura e dei congressi, Italia Room

Chairs: Rie RAFFING (SWE)

Healthy – regional – seasonal: Implementation of sustainable nutrition in a university hospital- A best practice example

Anna EISENBERGER, Gernot BRUNNER (AUT)

Healthy food environments: nudging consumers to healthier choices

Kia NOBLE, Gemma SMOKER (AUS)

Nutrition Education and Health Promotion through Short Videos and Animations on Social Media

Mia KAO, Joyce CHEN, Yi-Ping CHANG, Tina CHIU (TWN)

Evaluating a healthy lifestyle training course for a group of medical students during their learning visit in Hong Kong

Peter CHUK, Albert TSAI, Alan SIU (HKG)

PROGRAM DETAILS

THURSDAY, June 7, 2018

Eating habits and body mass index (BMI): questionnaire results from a large Japanese cohort

Toh Yoon WONG, Ayumi GONDO, Hirohiko MURATA (JPN)

O1.3 Smoking cessation

Venue: Sala Maggiore, Bologna Room

Chair: Miriam GUNNING (IRE)

Efficacy of intensive face-to-face interventions for smoking cessation

Mette RASMUSSEN, Bolette PEDERSEN, Susanne Vahr LAURIDSEN, Hanne TØNNESSEN (DNK)

The Effect of Smoking Cessation Services for The Inpatients on Smoking Abstinence Rate in a Taiwanese Population

Chi-Wei LIN, Wei-Chieh HUNG, Wei-Lin CHIN, Hsiu-Hui TSAI, Wei-Wei HONG, May-Fan LIOU, Tzu-Jung CHIU (TWN)

Smoking cessation counseling provided by trained health professionals in health services, workplaces, and in cancer screening settings

Sandra BOSI, Giuseppe GORINI, Cristina GOZZI, Francesca ZIRONI, Marco TAMELLI, Giovanni FORZA, Mateo AMEGLIO, Silvana WIDMANN, Eralda LICHERI, Grazia MERCATILI, Milena FRANCHELLA, Fabrizia POLO, Cristina MARCHESI, Carlo DI CLEMENTE (ITA)

O1.4 WORKSHOP: Creating Patient Engagement Standards for Health Promoting Hospitals

Venue: Sala Maggiore, Rossa A Room

Chair: Susan FRAMPTON (USA)

O1.5 Promoting the health of staff

Venue: Sala Maggiore, Rossa Room

Chair: Marie SERDYNSKA (CAN)

Meeting healthcare professionals for safety issues can lead to work wellbeing?

Mariangela SPINOSA, Teresa PALLADINO, Simonetta BIGNAMI, Daniele TOVOLI, Andrea MINARINI (ITA)

Occupational health service experts' influence on public organisation managers

Roy LIFF, Ewa WIKSTRÖM (SWE)

The impact of employee assistant programs (EAPs) on reductions of mental disturbance: Evidence from employees working in hospital in Taiwan

Chiao Chu WANG, Ming Ting CHEN (TWN)

A three month hospital-based exercise program was effective on decreasing sedentary behavior and rate of turn over

Chiao Chu WANG, Ming Ting CHEN (TWN)

Use lot technique and data analysis to setup an violence prediction and prevention system in ER

Chi-Feng Lin (TWN)

PROGRAM DETAILS

THURSDAY, June 7, 2018

O1.6 Early care and interventions

Venue: Sala Maggiore, Bianca Room
Chair: Isabelle AUJOLAT (BEL)

Risk Factors of Postpartum Depression in a Mother-Child Friendly Hospital Using Structured Equation Model

Lee-Ching HWANG, Hsin-Hui SHAO, Hsin-Lung CHAN, Wei-Hsin HUANG,
Shu-Chen LEE (TWN)

Korean Unwed Mothers' Mental Health and Intellectual Abilities

Naram HA, Suyeon JO, Soowon PARK, Jung Hae YOUN, Bo Kyung SOHN,
Hyo Jung CHOI, Ji Yeon LEE, Jin Yong LEE, Min Hyun PARK, Jun Young LEE (KOR)

Pre-pregnancy Body Mass Index, Gestational Weight Gain and Infant Birth Weight in Taiwanese primiparous women

Alexander WAITTS, Li-Yin CHIEN, Ying-Wei WANG (TWN)

Effectiveness of hearing screening in newborn population: A systematic review

Nai-Rong KUO, Chia-Yu LIU, Tao-Hsin TUNG (TWN)

Bridging the Gaps of Child Welfare: A Pilot Health Care Project in a Rural Area of Southern Taiwan

Meng Fan HSU, Po-Ching ChOu, Yu-Shuo HUANG, Mi-Chin HSIEH, Ying-Hsiao CHEN,
Joh-Jong HUANG (TWN)

O1.7 Age-friendly standards

Venue: Sala Maggiore, Rossa B Room
Chair: Astrid LOIDOLT (AUT)

Outcome Differences between Medical Centers and Community Hospitals in Recognition Project of Age-friendly Hospitals in Taiwan

Shan-Ching HUNG, Shu-Ti CHIOU, Shew-Meei SHEU, Hsin-Yi YANG, Jung-Ying HOU,
Yu-Cheng CHANG, Wei CHEN (TWN)

Optimised Aging – A Holistic and Salutogenic Approach with focus on Housing

Petter AHLSTRÖM, Börje BJELKE, Göran LINDAHL, Markus FELLESSON (NOR)

Effects of bed-exit alarm use to prevent falls in the nursing home

Yi-Chun KUO, Hui-Chun HUANG, Shu-NI CHUANG, Hsin-Yi YANG, Fang-Fei HU,
Hsiu-Chen HUANG, Wei CHEN, Huei-Chin HUANG (TWN)

Evaluating a healthy lifestyle training course for a group of medical students during their learning visit in Hong Kong

Peter CHUK, Albert TSAI, Alan SIU (HKG)

O1.8 **WORKSHOP: Promote equity to improve responsiveness to diversity: the Equity Standards tool**

Venue: Sala Maggiore, Ciano Room
Chair: Antonio CHIARENZA (ITA)

PROGRAM DETAILS

THURSDAY, June 7, 2018

Members of HPH Task Force Migration, Equity and Diversity

Antonio CHIARENZA (ITA), Bernadette Nirmal KUMAR (NOR), Ragnhild SPILKER (NOR), David INGLEBY (NED), Eeva HAKKINEN (FIN), Laura McHUGH (IRE), James GLOVER (IRE), Marie SERDYNKA (CAN), Karima KARMALI (CAN), Lidia HORVAT (AUS), Manuel FERNANDEZ GONZALEZ (SWE), Elizabeth ABRAHAM (CAN), Hans VERREPT (BEL), Manuel GARCIA-RAMIREZ (ESP), Roumyana BENEDICT-PETROVA (BEL))

O1.9 HPH and primary health services

Venue: Sala Maggiore, Indaco Room

Chair: Raffaele ZORATTI (ITA)

A pilot experience to train general practitioners in implementing health promotion and improving patient's involvement

Valentina CAPPI, Sandra BOSI, Ermanno RONDINI, Gianfranco MARTUCCI (ITA)

Idea Bank for Healthy Life Centers - a practical tool for health personnel for sharing knowledge and experiences

Inger Merete SKARPAAS, Jorunn KILLINGSTAD (NOR)

A Regional Health Care Concept for Primary Health Care Centers and Networks in Styria, Austria

Sarah BURGMANN, Muna ABUZHARA, Karl HORVATH, Andrea SIEBENHOFER, Martin SPRENGER (AUT)

Implementing health promotion, disease prevention and health literacy in primary care units – an Austrian Initiative

Daniela ROJATZ, Peter NOWAK, Susanna FINKER, Rainer CHRIST, Eva LEUPRECHT, Jürgen M. PELIKAN (AUT)

O1.10 WORKSHOP: Person centered re-orientation of Healthcare: the Italian case

Venue: Sala Maggiore, Magenta B Room

Chair: Giulio FORNERO (ITA)

Person centered re-orientation of Healthcare: the Italian case

Giulio FORNERO, Antonio CHIARENZA, Giovanni ROMANO, Giuseppina VIOLA, Cristina AGUZZOLI, Benedetta RIBOLDI, Raffaele ZORATTI, Luisa GIACOMINI, Emanuele TORRI, Ilaria SIMONELLI, Giorgio GALLI, Anna CASTIGLION, Patrizia PROSPERI, Claudio LAZZARI, Elisabetta CONFALONI, Lucia CELESTI, Alda COSOLA (ITA)

O1.11 WORKSHOP: New positioning for Healthy Hospital: Health-Literate Orientation

Venue: Sala Maggiore, Magenta A Room

Chair: Ying-Wei WANG (TWN)

14:15-15:45 Oral sessions 2

O2.1 Integrated health services

Venue: Sala Maggiore, Celeste Room

Chair: Sally FAWKES (AUS)

PROGRAM DETAILS

THURSDAY, June 7, 2018

The Implementation of Integrated Management Program of Chronic Obstructive Pulmonary Disease in Taiwan

Ming-Shian LIN, Ying-Wei WANG, Ran-Chou CHEN, Shu-Li CHIA, Way-Yi TSAI, Hui-Lan LEE, Wei CHEN (TWN)

Influence of the integrated care program on the healthcare utilization of hypertensive and diabetes patients in Taiwan

Pei-Chun YANG, Yi-Lien LIU (TWN)

Experience in caring for Rheumatoid arthritis patients by using an integrated health care model in Taipei TzuChi Hospital

Yi-Chia NI, Chen-Hung CHEN, Chin-Hsiu LIU, Chun-Hsiung CHEN (TWN)

Integrated home-based medical care in Taipei City Hospital

NN

Conceptualising Skill Mix in the Health Services

Jennifer CUNNINGHAM, John S.G. WELLS, Thomas O'TOOLE (IRE)

O2.2 Managing diabetes

Venue: Palazzo della cultura e dei congressi, Bologna Room

Chair: Valentina CHIESA (ITA)

Changing the Perception of the Healthcare System and Healthcare Organizations on Coping with the Diabetes Problem

Bishara BISHARAT, Aviad Tur-SINAI (ISR)

C.H.A.N.G.E.-D.: Developing and testing an innovative health promotion initiative for promoting health behavior change and self-management among people with diabetes in a national health service organization

Diane LEVIN-ZAMIR (ISR)

Taipei virtual diabetic hospital- an integrated care system

Kuan Ting HOU, Chung Sen CHEN (TWN)

Strategies to Prevent Type 2 Diabetes for the people with Pre-Diabetes in Health Promoting Hospitals (HPH) in Korea: 12-month Result of Intervention Program

Eun-Hee NAH, Jieun CHU, Seon CHO, Jong-Yil CHAI (KOR)

Clinical Implications of Diabetic Retinopathy Screening among Type 2 Diabetes: An Experience of Population-Based Study in Kinmen, Taiwan

Jorn-Hon LIU, Tao-Hsin TUNG (TWN)

O2.3 Addressing health equity

Venue: Palazzo della cultura e dei congressi, Italia Room

Chair: Bernadette Nirmal KUMAR (NOR)

The Swedish HPH network – a network for equal and health-promoting health service

Margareta KRISTENSON, Sofia DAHLIN, Lovisa KARLSSON, Ralph HARLID (SWE)

PROGRAM DETAILS

THURSDAY, June 7, 2018

The promotion of health equity and organizational planning: insights from an exploratory case study

Antonella CIFALINÒ, Irene Eleonora LISI, Emilio PASSETTI (ITA)

Addressing omissions in health care: training health professionals' cultural competence

Maidor BELINTXON, Olga LOPEZ-DICASTILLO, María Jesús PUMAR-MENDEZ, Agurtzane MUJICA, Nisha DOGRA (ESP)

Struggling for equity in sexual and reproductive healthcare for Roma women indisenfranchised Spanish neighbourhood

Manuel GARCÍA-RAMÍREZ, Marta ESCOBAR-BALLESTA, M-Jesús ALBAR, Virginia PALOMA (ESP)

Can Health Technology Assessment (HTA) contribute to safeguarding equity?

Luciana BALLINI (ITA)

O2.4 Health literacy for children and adolescents

Venue: Sala Maggiore, Indaco Room

Chair: Ilaria SIMONELLI (ITA)

Governance for young people: culture, structures and processes to enable health services and schools to be more health promoting

Cristina AGUZZOLI, Luisa GIACOMINI, Cinzia BRAIDA, Alessia COLONNA, Lidia DI STEFANO (ITA)

HI-FIVE: Health literacy-For young Individuals. Its Value for Empowerment and successful transition

Kjersti J. Ø. FLØTTEN, Britt NAKSTAD, Isabelle AUJOULAT, Anne Lee SOLEVÅG (NOR)

Patient Engagement: Teenagers Involvement

Lucia CELESTI, Elita VIOLA, Massimiliano RAPONI (ITA)

Reduced all-cause mortality among young men 24 to 26 years after a lifestyle health dialogue in primary health care

Hans LINGFORS, Lars-Göran PERSSON (SWE)

The RICA questionnaire: screening of the Internet Related Risk in Adolescence

Matteo KETTMAIER, Daniele MARAMALDO, Giulia TOMASI (ITA)

Evaluation of an intervention aimed at supporting new parents: the Baby Newsletter project

Costantino PANZA, Serena BROCCOLI, Laura BONVICINI, Alessandro VOLTA, Maddalena MARCHESI, Paolo Giorgi ROSSI (ITA)

O2.5 Good governance for HPH

Venue: Sala Maggiore, Ciano Room

Chair: Antonio Chiarenza (ITA)

From experience towards large scale implementation – the strategic objectives of the Austrian Network of Health Promoting Hospitals and Health Services

Gernot BRUNNER, Rainer CHRIST (AUT)

PROGRAM DETAILS

THURSDAY, June 7, 2018

Brand Strategy: Reinforcing the HPH Catalunya Network

Cristina INIESTA, Manel SANTIÀ, Anna Carol PÉREZ, Isabel RAMÓN, Maria BRIANSO, Marisa SERRA, Rosa SIMON, Anna FERRET, Dolors JUVINYÀ (ESP)

The Regional Management in Friuli Venezia Giulia (Italy) and the role in planning the HPH commitment

Giuseppe TONUTTI, Cristina AGUZZOLI (ITA)

Partnering in healthcare - a co-designed framework to deliver better healthcare and outcomes

Lidia HORVAT (AUS)

Implementing a people centered health promoting and social care model

Elvira MENDEZ (ESP)

Creating an Introductory Course in Scientific Article Writing

Rie RAFFING, Thor Bern JENSEN, Sanne LARSEN, Hanne TØNNESEN (DNK)

O2.6 Community health promotion I

Venue: Palazzo della cultura e dei congressi, Bianca Room

Chair: Federica GAZZOTTI (ITA)

Health services role in public health work and contribution to comprehensive, coordinated services – Examples from Municipal Healthy Life Centers

THE NORWEGIAN DIRECTORATE OF HEALTH HPH 2018

Henriette ØIEN (NOR)

Factors Associated with Papanicolaou test utilization by Taiwanese Women

Chia-Pei CHOU, Chih-Fang HUANG, Jui-Chin CHIANG, Kun-Siang HUANG (TWN)

Exploring new strategies of health promotion facilitating people to be the main actors. The Italian beFood project

Francesca PENNUCCI, Sabina DE ROSIS, Sabina NUTI (ITA)

Community-based volunteer training program to promote healthy diet for the elderly population

Yu-Shan HUNG, Tzu-Yang HAN, Tong-Yun HSIAO, Hung-Yu HSIEH,

Chung-Feng WENG (TWN)

Healthy Aging: Designing a Social and Digital Innovation Platform to promote Senior Volunteerism

Shou-Hsin CHIEN, Ching-Yuan CHEN, Cai-Ru GAN, Yi-Ling LAI, Pin-I CHANG,

Lin-Ying HSU (TWN)

Mobile health care in remote areas for elder diabetic patients in Taiwan

Kun-Siang HUANG, Chih-Chiang TAI, Shin-Yi GUNG, Pei-Ming WANG, Wei-An LAI,

Jui-Chin CHIANG, Chia-Pei CHOU (TWN)

PROGRAM DETAILS

THURSDAY, June 7, 2018

O2.7 Age-friendly care for the community

Venue: Sala Maggiore, Magenta B Room

Chair: Shu-Ti CHIOU (TWN)

Discussion on the Promotion of Elderly Health Promotion with the Theory of Lifelong Education. Experience sharing in promoting learning activities for the elderly in a district hospital

Yu-Mei CHEN (TWN)

Better life in the elderly. The Effectiveness of Interventional Exercise Consultation for Physical Fitness of The Elderly

Ta-Chuan HUNG, Lee-Hua LIAO, Tsu-Hsueh HUANG (TWN)

Community-based group exercise program in the elderly: a pilot study

Yu-Hsuan CHEN, Chih-Wen LIN, Jie-Ying WU, Li-Fong LIN, Ying-Chin LIN,

Yi-Su CHEN (TWN)

Effect of a Body-Mind Fitness Intervention Designed to Enhance Physical Fitness in the Community-based Elderly

Meng-Tien WU, Hsiu-Ling CHIANG, Chiung-Wen HSU, Pei-Li CHANG,
Chi-Chun CHOU (TWN)

Dementia friendly hospitals: Health care services reorientation through novel collaborations

Sofoclis BAKIDES, Stephanos VARVARESSOS, Nino KUSHITASHVILI,
Ilias GEORGAKOPOULOS, Evrydiki CHRISTAKOS, Andriani NIKOLAOU (GRC)

O2.8 WORKSHOP: Mental health - a challenge for the future

Venue: Sala Maggiore, Rossa A Room

Chair: Lise-Lotte RISØ BERGERLIND (SWE), Inger Kari NERHEIM (NOR)

O2.9 WORKSHOP: Paving the way for a health-oriented primary care: tools for implementing health promotion

Venue: Sala Maggiore, Rossa Room

Chair: Olga LOPEZ-DICASTILLO (ESP)

Development of an evaluation framework for health promotion in primary care

Olga LOPEZ-DICASTILLO, Elena BERMEJO-MARTINS, Elena ANTONANZAS,
Agurtzane MUJICA, Maria Jesus PUMAR-MENDEZ (ESP)

A taxonomy of omission errors in health promotion for improving safety in primary care

Maria Jesus PUMAR-MENDEZ, Agurtzane MUJICA, Andrea IRIARTE-ROTETA,
Naia HERNANTES-COLIAS, Antonio GARCIA-IRIARTE, Maider BELINTXON,
Cayetana RUIZ-ZALDIBAR, Olga LOPEZ-DICASTILLO (ESP)

Paving the way for a health-oriented primary care: tools for implementing health promotion

Olga LOPEZ-DICASTILLO, Agurtzane MUJICA, Elena BERMEJO-MARTINS,
Maider BELINTXON, Andrea IRIARTE-ROTETA, Cayetana RUIZ-ZALDIBAR, Naia
HERNANTES-COLIAS, Antonio GARCÍA-IRIARTE, Elena ANTONANZAS,
Maria Jesús PUMAR-MENDEZ (ESP)

PROGRAM DETAILS

THURSDAY, June 7, 2018

Health professionals' role in health promotion and prevention: analyzing nurses' functions in primary care

Andrea IRIARTE-ROTETA, Olga LOPEZ-DICASTILLO, Agurtzane MUJICA, Elena BERMEJO-MARTINS, Cayetana RUIZ-ZALDIBAR, Naia HERNANTES-COLÍAS, María Jesús PUMAR-MENDEZ (ESP)

02.10 WORKSHOP: Working Group on HPH and Health Literate Health Care Organizations

Venue: Sala Maggiore, Rossa B Room

Chairs: Jürgen M. PELIKAN, Peter NOWAK, Eva LEUPRECHT (AUT)

13:30-14:15 Mini oral sessions 1

M1.1 Integrated health care services

Venue: Sala Maggiore, Celeste Room

Chair: Christina DIETSCHER (AUT)

Effectiveness of Integrated Care Model for Type 2 diabetes: a population-based study in Reggio Emilia (Italy)

Valeria MANICARDI, Paola BALLOTARI, Francesco VENTURELLI, Francesca FERRARI, Massimo VICENTINI, Marina GRECI, Fabio PIGNATTI, Simone STORANI, Paolo Giorgi ROSSI (ITA)

The effect of using the senior-centered health services to increase the health care quality in TMUH in 2017

Chung-Ying LU, Ying-Hua SHIEH, Hsiung-Fei CHIEN (TWN)

M1.2 Alcohol prevention and lifestyle interventions

Venue: Palazzo della cultura e dei congressi, Italia Room

Chair: Jeff Kirk SVANE (DNK)

Association with alcohol use disorder and health promotion practices among first-year students of university, South Korea

Young Bok KIM (KOR)

Multilevel factors on the problem drinking among the university students in South Korea: Application of ecological model

Yeji LEE, Hyekyeong KIM (KOR)

Alcohol prevention by BRENDA and case management in New Taipei City and Taipei City

Chun-Kai FANG, Pao-Wen SHIH, Tzu-Ching YEH, Chia-Hua LIN (TWN)

Adaptation of a tool to improve hospital stays for people who use drugs

Carol STRIKE, Adrian GUTA, Soo Chan CARUSONE, Ann STEWART, Scott HARRISON, Ross UPSHUR, Grant COBB, Curtis COOPER (CAN)

PROGRAM DETAILS

THURSDAY, June 7, 2018

The perspectives of people who use drugs and health care providers about what leads to illicit drug use during hospital admissions

Carol STRIKE, Samantha ROBINSON, Adrian GUTA, Soo Chan CARUSONE, Darrell TAN, Bill O'LEARY, Ross UPSHUR (CAN)

Are doctors the new drug dealers?

Jana MULLEN, Joshua MULLEN (USA)

M1.3 Promoting the health of staff through physical activity

Venue: Palazzo della cultura e dei congressi, Bologna Room

Chair: Cristina INIESTA (ESP)

Exploratory Study on Three-year Effects of a Health Promotion Policy with Evidence-based Healthcare

Shu-Chen LEE, Li-Yun TSAI, Jung-Mei TSAI, Wei-Hsin HUANG, Li-Jen LIANG, Yu-Hua CHEN (TWN)

Improving the Healthy Physical Fitness Program of Medical Center Staff in Taipei with Social Cognitive Theory

Li-Wei WU, Tung-Wei KAO, Jing-Yi LIN, Pei-Jung HSU (TWN)

10000 steps per day: An intervention of health promotion in a university hospital in France, 2017

Sorina Dana MIHAILESCU, Damiano CERASUOLO, André GILLIBERT, Anne GRIBOUVAL, France-Isabelle MONTAIGU, Joël LADNER (FRA)

Staircase utilization rate among young people

Hiroto NAMBA (JPN)

M1.4 Health Literacy and Communication

Venue: Sala Maggiore, Rossa Room

Chair: Mariella MARTINI (ITA)

Effectiveness of a Shared Decision-Making Model in Enhancing Follow-Up Rate of Patients Tested Positive for Colorectal Cancer through Screening

Hsuan HO, Tang-Yu YA, Sung-Yun CHEN, Wen-Rui YU, Yi-Fan TSAI (TWN)

Verbal Education of Bowel Preparation by Telephone Increases the Efficacy of Bowel Cleansing

Feng Ying CHYN, Yi Chia NI, Jiann Hwa CHEN (TWN)

Assessing a Health Literacy Environment. Walking Interview about Navigation in SNU-SMG Boramae Medical Center

Eun Young HEO, Su Young CHOI, Dong Won SEOL, Min Hyun PARK, Hwan Cheol SON (KOR)

PROGRAM DETAILS

THURSDAY, June 7, 2018

M1.5 Workplace health promotion

Venue: Sala Maggiore, Ciano Room

Chair: Astrid LOIDOLT (AUT)

Immunization of Healthcare workers against HBV, measles, rubella, mumps and varicella in Local Health Authority of Reggio Emilia

Pietro RAGNI, Francesco MINEO, Giovanna MATTEI, Laura CAVAZZUTI, Patrizia CAMERLENGO, Valentina CHIESA, Giorgio MAZZI, Franco PERAZZOLI, Cristina MARCHESI (ITA)

Improving influenza vaccination uptake in health-care workers through attitude and behavioural changes in the Local Health Unit of Reggio Emilia, Emilia-Romagna Region

Cristina MARCHESI, Valentina CHIESA, Giovanna MATTEI, Patrizia CAMERLENGO, Pietro RAGNI, Francesco SONCINI, Federica GAZZOTTI, Irene MARCELLO, Giorgio MAZZI, Laura CAVAZZUTI (ITA)

The benefit of implementation multiple health promotion activities in hospital

Hsiu-Mei LIN, Yi-Ju LEE, Shu-Chen LEE, Wei-Hsin HUANG, Chi-Feng LIN (TWN)

The Effects of Team Resources Management Programs in Workplace- an Investigation in Department of Nutrition in Hospital

Wei-An LIN, Wen-Lin FAN, Chiu-Lan TSENG (TWN)

Process Reengineering for Hospital Patient Transporters

Chin-Yi LIN, Tzu-Ying CHEN, Szu-Ching SHEN, Wen-Chen TSAI, Kuang-Hua HUANG, Pei-Tseng KUNG (TWN)

M1.6 Promoting a healthy lifestyle in the community

Venue: Palazzo della cultura e dei congressi, Bianca Room

Chair: Dolores JUVINYA (ESP)

The Relationship between health risk behavior patterns and health-related quality of life among citizens in 25 regions of Seoul metropolitan area

Hyeyun KIM, Hyekyeong KIM (KOR)

Relationship between health risk lifestyle and health promotion expenses of the elderly

Kue Sook KIM, Ji Hong LEE, Yu Jeong LEE (KOR)

Lifestyle Factors Associated with Self-Reported Constipation among Taiwanese Youth aged 18-23 Years

Meng-Ting TSOU, Betty Chia-Chen CHANG, Ying-Ju CHEN, Wei-Hsin HUANG (TWN)

A clinical service dedicated to healthy lifestyles in Arcispedale Santa Maria Nuova IRCCS of Reggio Emilia and Civil Hospital of Guastalla

Marco TAMELLI, Annamaria FERRARI, Elisa MAZZINI, Francesco SONCINI, Anna PIFFER, Elena CERVI, Angela ACCARDO, Fabrizio BONI, Cinzia GENTILE, Giorgio MAZZI, Gianfranco MARTUCCI, Sandra BOSI, Ermanno RONDINI (ITA)

PROGRAM DETAILS

THURSDAY, June 7, 2018

“Outdoor gym” - Community health promotion and public health

Anna Maria FERRARI, Elena POPPI, Massimo MILANI, Evelyn IOTTI, Leris FANTINI, Gianni ZOBBI, Laura Lisa LORENZELLI, Alberto ARTIOLI, Mauro BEDOGNI, Simona GRASSELLI, Annalisa RABITTI, A.MUNARINI, Emiro ENDRIGHI, Patrizia FAVA, Cristina BIGNAMI, Barbara VOLTA, Michela COMPIANI, Maria Livia VIOLI, Marcello TEDESCHI, Sonia BUFFAGNI, Christian VERGALLI, Riccardo PELLI, Marco TAMELLI, Greta FONTANILI, Maurizio FERRARI, Ivano PRANDI, Filippo NOVELLI, Massimo CAOPELLI, Damiano RAZZOLI, Andrea ORLANDINI, Elisabetta BORETTI, Giacomina MONTANARI, Valentina BEDOGNI, Giorgio SALAMI, Cinzia ARALDI (ITA)

M1.7 Age-friendly care for the community

Venue: Sala Maggiore, Magenta B Room

Chair: Birgit METZLER (AUT)

Health Promoting Services of Aged Friendly Care in a Super-Aged Society, Experiences in a Rural Community in Northeast Taiwan

Yi-Wen TSAI, Yiu-Hua CHENG, Mei-Wen WANG, Shih-Han LAI, Yi-Chuan CHEN, Chien-Tzung CHEN (TWN)

A Study of Experiences of Health Promotion Activities for the Elders in a Rural Area of the North Coast of Taiwan Using a Humanoid robot

Hsiao-Yu CHANG, Shih-Chung CHIANG, Chia-Wen CHANG, Ching-Ting TAN (TWN)

Reproductive, Menstrual and Dietary Factors Associated with Bone Mineral Density in Postmenopausal Chinese Women

Chih-Chien CHENG (TWN)

M1.8 Equity in health promoting health care

Venue: Sala Maggiore, Rossa A Room

Chair: Ragnhild SPILKER (NOR)

Influence factor of unmet health care in the Republic of Korea

Kue Sook KIM, Ji Hong LEE, Yu Jeong LEE, Mi Jin YUN, Heui Geun RYU (KOR)

The health of Migrants and Vulnerables at the heart of policy of a Local Health Authority

Filippo GNOLFO, Elisabetta CONFALONI, Claudio LAZZARI, Ascanio IANNACE, Stefania TONETTI, Mauro GOLETTI (ITA)

A new model of drug instruction provided to multicultural citizens in Taiwan

Ming-Yi LAI, Chi-Tai LEE, Eric Kin-Lap LEE, Jin-Shiung CHENG (TWN)

Health Check-up Support for the Beneficiaries of Basic Livelihood Act: Two Years of the Coalition Experience and Outcomes of a General Hospital with Three Districts' Self-support Centers in Seoul, Korea

Jiyong PARK, Bumjo OH, Jaekyung LEE (KOR)

Return to work in Italian cancer survivors: the innovative social-health care network

Sara PALTRINIERI, Ermanno RONDINI, Stefania FUGAZZARO, Cristina GOZZI, Stefania COSTI, Elisa MAZZINI (ITA)

PROGRAM DETAILS

THURSDAY, June 7, 2018

M1.9 Mental health of patients and staff

Venue: Sala Maggiore, Indaco Room

Chair: Kjersti J. Ø. FLØTTEN

The Exploration of the Stress Perceptions among New nurses at the First year

Yueh-E LIN, Shu-Fang Vivienne WU, Hsin-Tzu HSIEH (TWN)

The Effectiveness of Religious (Buddhist Tzu Chi) Music in Relieving Stress on Medical Staff

Yinghsu JUAN

Mindfulness-based cognitive group therapy for hospital staff with psycho-physiological stress : An outcome study

Yi-Chun LIN, Chun-Chun LIN, Hui-Ting HUANG (TWN)

An Exploration of the Application of Empowerment Perspective to a Group for Middle Aged Women Repeated Suicide Attempters

Fu Nung HSU, Yi Wen LIAN, Chen Pang WANG, Huei-Lan LU (TWN)

M1.10 Implementing people-centered care

Venue: Sala Maggiore, Rossa B Room

Chair: Eeva HÄKKINEN (FIN)

Applying Network Analysis Method to Evaluate Outpatient Medical Service Quality: Case Study of Asia University Hospital

Jiunn-I SHIEH, Hsin-Hung WU, Kuan-Kai HUANG (TWN)

Prioritizing the provision of health information to support for the ability of self management of patients at health promoting hospital

Heui Sug JO, Su Mi JUNG (KOR)

Active screening the distress among cancer inpatients

Chih-Ju LIU, Chun-Kai FANG (TWN)

Using the Case Management to Care the Breast Cancer Patient with the Side Effects of Chemotherapy

Yi-Hsuan LU, Chia-Ning CHANG, Ching-Hsuan LO, Dian-Kun LI, Shou-Hsin CHIEN (TWN)

Nursing Experience of Caring an Oral Cancer Patient Having Body Image Change after Surgery

Ling-Chen LIAO, Ching-Hsuan LO, Dian-Kun LI, Shou-Hsin CHIEN (TWN)

Home-based occupational therapy to reduce disability and enhance social reintegration in complex patients in Reggio Emilia

Martina PELLEGRINI, Stefania FUGAZZARO, Stefania COSTI, Margherita SCHIAVI (ITA)



The Two Towers

PROGRAM DETAILS

THURSDAY, June 7, 2018

13:30-14:15 Poster sessions 1

P1.1 Age-friendly care in the community and at home

Venue: Sala Maggiore, second floor

- P 1. Exploring the Effect of Supportive Group for Nursing Home**
Shiow-Ching LIANG, Tzu-Chuan LIN, Chion-Fang Pai, Chia-Chi YEN (TWN)
- P 2. A Preliminary Study of Age-friendly Priority Services on Outpatient Waiting Time and Satisfaction in a Regional Hospital**
Shao Yu HSU, Shuh Ju WANG, Hsiu Yu LIN, Chih Sheng CHOU, Pei Fang TSAI, Yueh Shun LU, Chih Kuang LIU (TWN)
- P 3. The Experience of Health Promotion Services for Community Elderly by Medical Center**
Shu-Chen LEE, Jung-Mei TSAI, Wei-Hsin HUANG, Jui-Yun CHUANG, Li-Jen LIANG, Yu-Hua CHEN, Chia-Mei CHANG, Chiu-Chen CHEN (TWN)
- P 4. Modification of the Home Environment - A Research for Yanchao District community-Dwelling Elderly in Kaohsiung**
Pei-Ching LIN, Ching-Wen WANG, Rui-Yi TANG, Ya-Ai CHENG (TWN)
- P 5. Learning effectiveness of foreign caregiver by using communicated tool (finger cards) at home care service**
Chiao-Chi YANG, Chia-Lin SHEN, Wen-Hsin HU, Hsueh-Ping YEH, Sung-Yun CHEN, Yi-Fan TSAI (TWN)
- P 6. A Study of Behavior in the Residential Bathroom Environment from the Perspective of the Elderly**
Ming-Shih CHEN, Hui-Yen LIAO, Pei-Hsuan LEE (TWN)
- P 7. Improve home care quality and reduce hospitalization in an aged society-an experience of a community based hospital home care project in Northern Taiwan**
Yiu-Hua CHENG, Yi-Wen TSAI, Mei-Wen WANG, Shih-Han LAI, Yi-Chuan CHEN, Chien-Tzung CHEN (TWN)
- P 8. Outcomes assessment of a multidisciplinary intervention programme for family caregivers of people with dementia in Taiwan**
Chan Li CHU, Ying-Jyun JIANG (TWN)
- P 9. A Study of Using Multiple Health Promotion Strategies to Prevent Dementia among Community-dwelling Elderly**
Tong-Yun HSIAO, Hung-Yu HSIEH, Yu-Shan HUNG, Chung-Feng WENG, Chun-Han TSENG (TWN)
- P 10. The Efficacy of Reminiscence Therapy on the Elderly in the Community**
Mei-Jou LU, Li-Shiu CHOU, Luan-Chen LIN, Hsiu-Chu LIU (TWN)
- P 11. Combining cognitive elements into routine group physical activities to improve motivation and participation of elderly with mild to moderate dementia: a dementia day care center experience in southern Taiwan.**
Po-Yen CHEN, Huei-Lan LU (TWN)

PROGRAM DETAILS

THURSDAY, June 7, 2018

- P 12. Culinary activities help improve the eating and meal preparation behaviors of dementia elders in Day Care Center**
Hui-Fang HUANG, Yu-Tai LO, Chin-Chi YE, Wen-Chin LIOU, Yi-Hua YANG (TWN)
- P 13. The Effect of a Nutrition Education Workshop on the Frailty of Seniors Living Alone**
Huang-Yu CHANG, I-Hsin TSENG, Lin-Hui LI, Chiu-Ping HSU, Hsueh-Chien CHENG, Sheng-Hua TSAI, Yu-Wen LIN, Nan-Ping YANG, Ching-Feng LIN (TWN)
- P 14. To evaluate the effectiveness of Diversified, Nutritionally Balanced, “Ready-to-Eat” Texture-Modified Meals in helping to improve the nutritional intake of institutionalized residents with dysphagia.**
Magdalin CHEONG, Hui-Hsien CHONG, Ying-Xiao HUANG, Jessica TAN
- P 15. Community-Based Physical Activity Programs for Older Adults to Establish a Positive Cultural Attitudes toward Health and Exercise**
Yi Hui LIN, Chiao Yu YANG, Chun Han TSENG, Hung Yu HSIEN, Chung Feng WENG, Yu Shan HUNG, Hsin Chun CHEN (TWN)
- P 16. Research on Promoting Age-Friendly City Eight Domains and Falls Prevention for the Elderly in Community**
Chun-Han TSENG, Hung-Yu HSIEH, Chung-Feng WENG, Yu-Shan HUNG, Hsin-Chun CHEN (TWN)
- P 17. Evaluation of fall prevalence and risk factors on community-dwelling middle-age and elderly using a multifactorial questionnaire in Taiwan**
Hsun-Pai WU, Chia-Chen LIN (TWN)
- P 18. The relationship between physical activity and depression symptoms among single elderly**
Chien-Min HUANG, Chen-Yu LIN (TWN)
- P 19. Impact of Physical Fitness and Balance Training on Frailty among Community-Dwelling Elderly with Frailty**
Liou-I HSIU, Min-Hui LI, Wan-Yun HUANG, Sin-Ying JHONG, Jin-Shiung CHENG (TWN)
- P 20. The effect of physical fitness training on balance ability in community elders in Taiwan**
Min-Hui LI, Liou-I HSIU, Wan-Yun HUANG, Sin-Ying JHONG, Jin-Shiung CHENG (TWN)
- P 21. The Influence of Elderly Age on Metabolic Syndrome and Muscle Strength**
Po-Yu ZHUANG, Ching-Fen CHIN, Jin-Jiun HONG, Meng-Tien WU, Ling-Yu HUNG (TWN)
- P 22. The effect of exercise on physical fitness and quality of life in patients with osteoarthritis of the knee.**
Mei-Hsueh KUO, Shun-Jen CHANG, Chien-Hung LIN, Chia-Chi YEN, Ming-Fen CHENG (TWN)
- P 23. Can the project of oral health promotion improve oral health in elderly?**
Yen-Fang CHOU, Suh-Ing HSIEH, Yi-Ling CHANG, Wen-Ming LIN, Tzu-Hsin HUANG (TWN)
- P 24. Constructing community comprehensive long-term care services system for older people with disability**
Yu-Tai LO, Chun-Wei KONG, Shu-Han YANG, Wen-Chin LIOU, Yi-Hua YANG (TWN)

PROGRAM DETAILS

THURSDAY, June 7, 2018

- P 25. Horticultural Therapy Project for Elder with Mild Dementia**
Huoy-In LIOU, Wen-Ling TSAI, Yu-Chu CHUNG (TWN)
- P 26. Relationship between body mass index and quality of life among older people in a rural area of Taiwan**
Pei-Ling WU, Hsin-Yi YANG, Kuan-Fen CHEN, Ching-Yi YANG, Hsin-Yu AN, Jung-Ying HOU, Wei CHEN (TWN)
- P1. 2 Age-friendly hospitals**
Venue: Sala Maggiore, second floor
- P 27. The Effects of Citizens' Medical Caretaker Program in Taoyuan City**
Wan-Ling CHEN, Pei Chen YANG, Yi-Lien LIU, Mei-Chen CHEN, Wei-Shan CHANG (TWN)
- P 28. Hospital Discharge Planning integrated with Longterm Care Service**
Ying Hui CHEN, Yi-Lien LIU, Pei Chun YANG, Yi Chen LU (TWN)
- P 29. Establish the strategy of referral program from Hospital discharge planning to Long Term Care Center**
Ying O CHEN, Shu Chao LIN, Chun Yi WU, Miao Ju FANG, Su E HSIEH, Hsiu Chen LIU, Tsung Lung TSAI (TWN)
- P 30. The Experience of Implementation Inpatient Discharge Link Up Long-term Care in the District Hospital in Southern Taiwan**
Chiou-Yu WU, Yi-Jing HONG, Jing-Wen QIU, Jer-Ming CHANG (TWN)
- P 31. The Effects on Environment Improvement of Age-Friendly Hospital —Taking One Regional Teaching Hospital in Taiwan as an Example**
Yenh-Chen HSEIN, Li-Chun CHEN (TWN)
- P 32. The practice of Age-friendly care embody the architectural Accessible design of the hospital building: An Example of a Health Promoting Hospital in Taiwan**
Kuo-Hsing LIN, Wen-Ke CHAO, Ching-Chieh LEE, Ming-Feng HOU, Tien-Sheng TSAI (TWN)
- P 33. Relevance between Self-evaluation and Movements of Osteoporosis and Locomotive Syndrome**
Chiachia YEH (TWN)
- P 34. A Quantitative Research Study of World Health Organization 10-Minute Simple Screening Tool and Study of Osteoporotic Fractures (SOF)**
Hsi-Lung HUNG, Hui-Wen PAI, Hui-Fei YANG, Huei-Yu LEE (TWN)
- P 35. An integrated program of geriatric comprehensive care reduces the 1-year mortality rate of hospitalized fragile fracture patients**
Tsung-Yu TSAI, Chung-Hwan CHEN, Chia-Hsin CHEN, Yu-Chih LIN, Kuan-Yun CHAO, Tzu-Jung FANG (TWN)
- P 36. Screening Tools to Assess Nutritional Status among Elderly Inpatients**
Luan-Chen LIN, Li-Shiu CHOU, Pei-I LIN, Chiu-Hsiang WU, Hsiu-Chu LIU, Mei-Jou LU (TWN)

PROGRAM DETAILS

THURSDAY, June 7, 2018

- P 37. Achievement of oral care activities by the dental hygienists at the general hospital**
Miyuki SAITO, Rika KATO, Takao SAITO, Ayumi YAMADA, Tetsuya SHINOBI, Isao FUKUBA (JPN)
- P 38. Using Tuka Education Model to Improve The Correct Rate of Wound Dressing For Elder Patients and Caregivers**
Shu-Chuan CHIANG , Hui-Shan CHEN, Ssu-Yu LAI, Ya-Mei CHANG, Mei-Chuan WU (TWN)
- P 39. Effectiveness of using acupressure on elderly patients with chronic constipation**
Wen-Hsuan SU, Jia-Ling WU, Shean-Jen DING , Sung-Yun CHEN, Yi-Fan TSAI (TWN)
- P 40. Elderly Experience for All Staff – Creating Organizational Culture**
Fang-Lun CHANG, Pei-Shuang WU (TWN)
- P 41. Construction of Silver-Haired Friendly Working Environment Model (Based on Taipei Tzu Chi Hospital)**
Ming-Hsiang CHEN, Yi-Cheng HOU, Yu-Ling HSIEH (TWN)
- P1.3 Chronic disease management I**
Venue: Sala Maggiore, second floor
- P 42. A nationwide strategy in preventing cardiovascular disease**
Hsing-Yi CHANG, Shu-Li CHIA, Chien-Ming CHOU (TWN)
- P 43. Experience and Report of Screening Program for Rheumatic Heart Disease among School-aged Children in Kiribati from Taiwan**
Yung-Wei HSU, Wen-Han CHANG, Shou-Chuan SHIH, Wan Ti HSU (TWN)
- P 44. Factors associated with pre-hospital delay in Korean patients with ST-elevation myocardial infarction**
Hee-Sook KIM, Sang Jun EUN, Kun-Sei LEE (KOR)
- P 45. Quality of Life and Associated Factors Among Stroke Patients in Korea: From 1 Year Outpatient Follow up after Attack**
HeyJean LEE, Jiyoung MOON, YoungKwon PARK, Seongheon KIM, Keonyeop KIM, Min-Ho SHIN, JungGook SONG, Soon-Ki AHN, Gil-Won KANG, Young-Hoon LEE, Byoung-Gwon KIM, Heeyoung LEE, Won Kyung LEE, Ki-Soo PARK, Kun Sei LEE (KOR)
- P 46. Weight gain and risk of cardiometabolic diseases among middle-aged women: using a reversible multistate Markov model**
Lee-Ching HWANG, Chyi-Huey BAI, San-Lin YOU (TWN)
- P 47. Dose Heart Rate Variability Predict Incident Cardiometabolic Risk in the Longitudinal Study**
Tung-Wei KAO, Yuan-Yuei CHEN, Li-Wei WU, Wei-Liang CHEN (TWN)
- P 48. The Atherosclerosis Risk in Metabolically Healthy Obese Pre-Diabetes**
Suyoung KIM, Eun-Hee NAH, Seon CHO, Jong-Yil CHAI (KOR)
- P 49. Association of Peptic Ulcer Disease with Metabolic Syndrome in Taiwan**
Pei-Yu YANG, Jung-Yu SHEN, Yao-Hsuan HSIEH, I-Ching LIN (TWN)

PROGRAM DETAILS

THURSDAY, June 7, 2018

- P 50. The Prevalence of Dyslipidemia and Development of a Health Promotion Plan in 8798 Taiwanese elderly Citizens**
Meng-Szu LEE, Ming-Lun YEH, Shu-Ching LIN, Hsiang- Ju KUO, Yu-Kuei HSU, Jeng- Fu YANG, Chia-Yen DAI (TWN)
- P 51. Supporting the daily work to promote a healthy lifestyle in patients with chronic rheumatic diseases – development and implementation of a structured model for specialist care**
Ann-Marie CALANDER, Mathilda BJÖRK, Nina BRODIN, Caroline LILJEQVIST, Maria NYLANDER, Alexandra ROTH, Björn SUNDSTRÖM, Emma SWÄRD, Susanne PETTERSSON (SWE)
- P 52. Implementation of guidelines for treatment of osteoarthritis in the south of Sweden**
Karin ÅKESSON (SWE)
- P 53. Implementation of Fracture Liaison Service for Closing the Osteoporosis Treatment Gap**
Wei-Chieh HUNG, Wei-Lin CHIN, Tzu-Jung CHIU, May-Fan LIOU, Chih-Yin LIN, Wei-Wei HONG, Hsiu-Hui TSAI, Chi-Wei LIN (TWN)
- P 54. Prediction of Probability of the Elderly Osteoporotic Fracture and exploration of correlation factors. A regional teaching hospital in East Taiwan**
Tse-Tsung LIU, Jia-Jie WANG, Su-Jung LIAO (TWN)
- P 55. Relationship between Helicobacter pylori infection and bone mineral density**
Bo-Lin PAN, Song-Seng LOKE, Chih-Fang HUANG, Jui-Chin CHIANG (TWN)
- P 56. A Study on Self-Management Behaviors and Related Factors in Patients with Chronic Obstructive Pulmonary Disease**
Yi-Ya CHANG (TWN)
- P 57. Using Information System Support Decision Making to Promote Emergency Medical Quality for Stroke Patients**
Yen-Wen LU, Chi-Hsun LIEN, Pei-Shan TSENG, Choa-Hsin WU, Ya-Hui CHEN, Jung-Ching LI (TWN)
- P 58. To improve the rate of rehabilitation care of stroke patients through the case management model: a 3-year experience**
Mu-Sheng HUANG, Hui-Chuan WU, Pei-Ju HUANG (TWN)
- P 59. Health Cognitive, Attitude and Health Behavior in Patients with Chronic Obstructive Pulmonary Disease: A Cross-sectional Analysis**
Pin-Yun CHANG, Hung-Ju CHEN, Yin-Ying WANG, Yi-Chen LEE, Tuan-Jung, Jong-Rung TSAI, Sung-Shan CHANG (TWN)
- P 60. Pharmaceutical Department Data: potentialities in the management of chronic obstructive pulmonary disease**
Annamaria PANCIROLI, Elisa BENEVENTI, Marco CODELUPPI, Debora RINALDI, Bettina MARCONI, Onorato FERRARI, Anna CIONI, Fabrizio BONI, Laura GABRIELLI (ITA)

PROGRAM DETAILS

THURSDAY, June 7, 2018

- P 61. Using mobile nursing model to improve Asthma control status by teaching using inhaler device correctly**
Ya-Ling KUO, Yu-Huey HUANG, Hui-Fei CHEN, Tsung-Huai KUO, Ai-Wei SHIH (TWN)
- P1.4 Disease management programs for NCDs**
Venue: Sala Maggiore, second floor
- P 62. Combination of Shared decision making and Share model of truth telling in cancer care**
Tzu Pin CHANG, Fang Ming CHEN, Sui Yu TAI, Tzu Hua CHEN (TWN)
- P 63. Reducing Urine Leakage After Radical Retropubic Prostatectomy: Pelvic Floor Exercises or Magnetic Innervation?**
Shu-Hui FENG, Yen-Ho LAI, Chia-Chiba LIN, Yun-Ya CHEN, Wen-Hui LUO, Fu-Lien CHUA, Jin-Shiung CHENG
- P 64. Clinical Outcome of Pap smear Screening in Outpatient Medical Treatment – An Example of a District Teaching Hospital**
Mei Chun CHEN, Li Yang CHEN (TWN)
- P 65. Analyzing Colorectal Cancer Screening Effect in a Taiwanese Regional Hospital**
Jui-Lan FANG, Chin-Ju LI, Yu-Pei LIN, Cheng-Nan HSIEH, Ming-Fen CHENG (TWN)
- P 66. Integrate the resources of the public and the private company to provide real hair wigs for the patients with breast cancer**
Ling-Yu LIN, Chia-Ning CHANG, Dian-Kun LI, Chao-Chen HUNG, Ching-Hsuan LO, Shou-Hsin CHIEN (TWN)
- P 67. Study on hot water foot bath to terminal cancer patients' sleep quality and effect to family caregiver**
Meihui CHEN (TWN)
- P 68. Study of Affecting Factors About Acceptance of Mammography Among Women in a Hospital in Southern Taiwan**
Yuh-Wei WANG, Kuo-Chi HUNG, Hua-Kuei LEE (TWN)
- P 69. Interventions to Improve Follow-up After Abnormal Breast Cancer Screening - A Case Study of the Hospital in South Taiwan**
Yi-Yun CHEN, Tzu-Chen PAI, Yi-Ting LIN, Yu-Pei LIN (TWN)
- P 70. Analysis of association between the physical and psychological resilience and the physical symptom distress occurs during the chemotherapy in patients with breast cancer**
Shuyi KAO (TWN)
- P 71. Effectiveness of Yoga Intervention in Breast Cancer-related Lymphoedema: A Systematic Review**
Ching-Wen WEI, Ching-Chi CHI, Tao-Hsin TUNG (TWN)
- P 72. Tackling Obesity by Developing Evidences-based Guideline on Adult Obesity Prevention and Management in Taiwan**
Kuen-Cheh YANG, Kuo-Chin HUANG, Yi-Ching YANG, Ying-Wei WANG, Li-Ju LIN, Chen-Su LIN, Chiung-Dan CHANG, Wei TSENG, Li-Hui YU (TWN)

PROGRAM DETAILS

THURSDAY, June 7, 2018

- P 73. Strategies to Enhance Cardiac Rehabilitation Rate in Patients with Coronary Artery Disease**
Cheng-Chang CHENG, Yi-Jen CHEN, Qiao-Ying HUANG, Tsung-Yu TSAI, Tsung-Hsien LIN (TWN)
- P 74. Stroke patients' Quality of life before and after active rehabilitation treatment: A Prospective Study**
Su LEE, Yu-Jo YEH, Tsung-Yu TSAI, Hon-Yi SHI (TWN)
- P 75. To develop inpatient caring recovery process for Post-acute Care - Cerebrovascular Diseases**
Tung-Yun WU, Yi-Jen WU, Pei-Shan YU, Pei-Lin LIAO, Hsiao-Wen HUANG, Shu-Ting CHUANG, Sou-Hsin CHIEN (TWN)
- P 76. Influencing factors of using mammography among women in southern Taiwan**
Yuh-Wei WANG, Kuo-Chi HUNG, Hua-Kuei LEE (TWN)
- P 77. Cooperative Management For Radiation Dermatitis**
Chia-Fen TSAI, Chun-Ming HUANG, Hsiao-Ping SHIH, Jen-Yang TANG (TWN)
- P 78. Analysis of Self-recorded chemotherapy induced peripheral neuropathy by Ovarian Cancer Patients**
Hui-Chun HSU, Mei-Yao HO, Shiow-Rong JEANG, Shang-Liang WU, Su-Yu TSAI, Tzu-Chan LU, Jin-Shiung CHENG (TWN)
- P1.5 Environment-friendly (sustainable) health care**
Venue: Sala Maggiore, second floor
- P 79. Building a Green Hospital at a Health Hospital in Taiwan: A Case Study by Energy Saving Project by ISO50001 Standards**
Tsung-Ming HO, Wen-Ke CHAO, Shuang-Ning YANG, Kuo-Hsing LIN, Ming-Feng HOU, Tien-Sheng TSAI (TWN)
- P 80. Building an Environment-Friendly Hospital by "Standards of Friendly-Building System": A Best Practice of Health Hospital in Taiwan.**
Wen-Ke CHAO, Tsung-Ming HO, Yung-Cheng LIU, Kuo-Hsing LIN, Ming-Feng HOU, Tien-Sheng TSAI (TWN)
- P 81. Towards an energy saving, money saving and environmental friendly hospital.**
Chih Cherng YANG, Jen MING, Chi-Woon KONG, Winston HUANG (TWN)
- P1.6 Equity in health promoting health care**
Venue: Sala Maggiore, second floor
- P 82. Concerned about the front-line service - full-time service does not fight**
Chen-Ni KO, Pei Chen YANG, Wan-Ling CHEN, Yi-Tin CHEN, Yi-Lien LIU (TWN)
- P 83. Emergency medical care services of an aboriginal area in eastern Taiwan**
Peng-Sheng CHEN, Hsiu-Nien CHANG (TWN)
- P 84. Sex differences in the effect of Type 2 Diabetes on Major Cardiovascular Diseases: results from a population-based study in Italy.**

PROGRAM DETAILS

THURSDAY, June 7, 2018

Valeria MANICARDI, Paola BALOTTARI, Francesco VENTURELLI, Francesca FERRARI, Massimo VICENTINI, Marina GRECI, Paolo Giorgi ROSSI (ITA)

- P 85. Strengthen the healthcare in Indigenous areas around Kaohsiung, Taiwan**
Pei-Shih WANG, Chia-Yu CHEN, Tsan-Teng OU, Wei-Ling HUANG (TWN)
- P 86. Creation of an organizational model (research-action) for an integrated community intervention on health promotion in an urban area of Rome (Bastogi)**
Maria Alessandra BRANDIMARTE, Silvia IORIO, Adelaide LANDI, Lorenzo PAGLIONE, Giovanni BAGLIO, Laura CACCIANI, Anna Maria BARGAGLI, Alessandro RINALDI, Elisabetta CONFALONI, Paolo MARCHETTI, Claudio LAZZARI, Maurizio MARCECA, Flavia SESTI, Enrico DI ROSA (ITA)
- P 87. What can be seen from free Medical Check-up & Consultation services for foreign immigrants?**
Tomoe KONO, Kozo TAKEMOTO, Isao FUKUBA, Tetsuya SHINOBI, Keiko TAKAHASHI, Mayumi INAMURA (JPN)
- P 88. Equal opportunity to access a Cath lab facility in a timely fashion for patients with acute coronary syndromes admitted to Spoke and Hub center: Reggio Emilia province experience**
Francesca MANTOVANI, Vincenzo GUIDUCCI, Alessandro NAVAZIO (ITA)
- P1.7 Healthy nutrition**
Venue: Sala Maggiore, second floor
- P 89. 'MUST' nutrition screening system with dietitians single visit health education can effectively improve nutritional status**
Wan-Ruei CAI, Yi-Cheng HOU, Hsin-Yi TSAO, Jing-Huei WU, Yu-Ling HSIEH (TWN)
- P 90. The prognostic importance of objective nutritional index in patients with respiratory failure**
Chi-Ting LI, Ming-Chieh LEE (TWN)
- P 91. Comparing community clients of different dietary pattern on their health indicators at a vegetarian festival in Hong Kong**
Peter CHUK, Albert TSAI, Alan SIU (HKG)
- P 92. Individualized nutrition intervention can effectively improve the nutritional status of psychiatric patients**
Yu-Ling HSIEH, Yi-Cheng HOU, Ming-Hsiang CHEN, Yi-Ting FANG, Xin-Yan ZHANG, Jing-Huei WU
- P 93. Effects of Health Management Program-Healthy Diet Change My Life**
Luan-Chen LIN, Shu-Hui WANG, Pei-I LIN, Chi-Chun HUANG, Cheng-Chung CHEN (TWN)
- P 94. The effective of online social media on weight management program in obese adult**
Yuen-Yuen LING, Wan-Jung Tien, Ke-Chen HUNG, Kuei-Ying HUANG (TWN)
- P 95. Application of online videos combining QR codes to promote nutrition education for hospital staffs**
Tzu-Yi CHEN, Chih-Fan CHIANG, Jing-Meei LIN, Pey-Rong CHEN (TWN)

PROGRAM DETAILS

THURSDAY, June 7, 2018

- P 96. Knowledge, attitudes and practices (KAP) related to dietary sodium among Taipei residents**
Yi-Jhen HO, Wan-Pei SHIH, Shan CHAO, Chun-Chieh WU, Chih-Kuang LIU, Pey-Rong CHEN (TWN)
- P 97. Correlation between nutrition flow chart and improving nutrition intake of cancer inpatients**
Chin Lien LAI, Chia I KO (TWN)
- P 98. “Sukoshio” survey in staff vs community members.**
Sanae KAKIUCHI, Fumihiko SAITOH, Kyota NEGISHI, HPH Committee in Oizumi Health Coop Hospital, Health Promoting Committee in Nerima (JPN)
- P 99. Why are patients indifferent to the hospital’s treatment diet?**
Hyun Young HA, Moo Young LEE, Dong Won LEE (KOR)
- P 100. Critical patients suffering chronic renal failure supplied with short-term high or normal protein diet does not affect liver and kidney function status**
Yan Chen SU, Chia-Heng LIN, Yi Cheng HOU (TWN)
- P 101. Improvement Project Reduce of Omission Rate Between the Recovery Room and the Ward Shift Change**
Huei-Ling TSAI, Shu-Chuan CHUANG, Jing-Fen LI, Feng-Ling CHEN, Jin-Shiung CHENG (TWN)
- P 102. Health promotion, Mediterranean diet and environmental sustainability. Empowering citizens through the FICO foundation for food education**
Chiara GIBERTONI, Paolo PANDOLFI, John Martin KREGEL, Luciana PRETE (ITA)
- P 103. A vegetarian diet may protect against cataract in past smokers**
Tina H. T. CHIU, Chia-Chen CHANG, Ming-Nan LIN, Chin-Lon LIN (TWN)
- P1.8 Improving the mental health of staff**
Venue: Sala Maggiore, second floor
- P 104. Staff self service mobile care-mended health**
Yi-Lien LEE, Ya-Han HU (TWN)
- P 105. A Discussion on Correlation Coefficient of Health Promotion Behavior of Nursing Practitioners**
Hsueh-Chen LAI (TWN)
- P 106. Support groups help employees relieve stress as novice parents**
Hsiu-Yu CHOU, Yu-Tai LO, Wen-Chin LIOU, Yi-Hua YANG (TWN)
- P 107. Explore the happiness feelings of nurses before and after participating in health promotion activities**
Su-Wan Chuang, Kang-Pan Chen, Chiu -Yu LIN, Jin-Shiung CHENG (TWN)
- P 108. Research on Hospital Promoting Workplace Health Promotion Activities and Employee Job Burnout**
Hui-Lan HUANG, Yu-Chun HSU (TWN)

PROGRAM DETAILS

THURSDAY, June 7, 2018

- P 109. An examination on the relations between nursing personnel's workplace environment and workplace health promotion**
Hsueh-Chen LAI (TWN)
- P 110. Quality of Life and Health Promoting Lifestyle among Mental Hospital Staffs**
Hsiao-Ju SUN, Ying-Chi CHUANG, Su-Jung LIAO (TWN)
- P 111. The Maternal Health Protection Project for health care workers**
Yin Chen CHEN, Tzu-Yun LIN, Xiao-Jie HUANG, Chao-Ling WANG, Wei-Ling HUANG (TWN)
- P 112. Factors increasing health care providers burden in Geriatric Acute Ward at a tertiary Hospital**
Ju-Hsien WU, Chun-Hsiung HUANG, Hung-Yu SUN, Yu-Jun CHANG, Ciao-Cyue CHEN (TWN)
- P 113. Evaluation the efficacy of health promotion hospital that promoted by the comprehensive workplace health promotion (CWHP) model.**
Yu-Wen LIN, Li-Ling SU, Ming-Lun HSIEN, Nan-Ping YANG, Ching-Feng LIN (TWN)
- P 114. Impact of the Center for Postpartum Health on Workplace Health Promotion**
Mei-Ling CHEN, Hsiu-Hua CHEN, Ming-Tsung LEE, Chang-Sheng LIN, Ai-Wei SHIH (TWN)
- P 115. "Creating a Happy Work Place": A Health Promotion Project for Hospital Pharmacists in Boramae Medical Center in Korea**
Jung Ae HEE, Choi Dan HEE, Jung Sun HOI (KOR)
- P 116. The effect of introducing mindfulness courses to enhance employee mental health at hospital**
Hui-Tzu CHEN, Chun-Kai FANG, Hsiu-Mei LIN, Li-Chun LO, Shu-Chen LEE, Wei-Hsin HUANG (TWN)
- P 117. Exploring the Effectiveness of Applying Mindfulness Skills to Promoting Workplace Health Promotion**
Su-Fen GONG, Huei-Lan LU (TWN)
- P 118. The Exploration of Job Engagement and Related Factor among Operating Room Nurses**
Ming-Ying CHIN, Whie-Mei SHIH, Tao-Hsin TUNG (TWN)
- P 119. A comparison of job stress, practice environment, occupational burnout, and organizational commitment among nurses in three different levels of hospitals in Taiwan**
Ru-Wen LIAO, Chen-Han WU, Yi-Chyan CHEN, Mei-Ling YEH (TWN)
- P 120. Studies of health status with employees who long night work and induce disease by abnormal workload**
Hung-An HSIEH, Hsing-Yu LIU, Meng-Tsung CHENG (TWN)
- P 121. Mobile Application Software (LINE@) Is Useful to Promote Staff Willingness to Participate Health Promotion Activities**
Chin-Ru CHUANG, Mei-Wei LING, Shu-Chuan YU, Meng-Tien WU, Ling-Yu HUNG (TWN)

PROGRAM DETAILS

THURSDAY, June 7, 2018

- P 122. Increasing Resilience among Nurses in Intensive Care Units**
Yueh-Wen KAO (TWN)
- P 123. Violence Prevention Program for Emergency Rooms**
Wan Ling LIAO, May Shu LI, Jen Yi CHEN (TWN)
- P 124. Using Maslow Theory of Needs to Explore Relevant Factors of Nursing Staff's Wish to Leave**
Chiu-Feng WU, Li-Hua CHIAO, Tsai-Tsu SU, Li-Ying YU, Chin-Min HUANG, An-Na TENG (TWN)
- P 125. Relationships among nurses' weekend experience, emotional experience, and recovery from work**
Ling-Sui CHEN, Yen-Hung KUO, Hui-Chen CHEN, Wei-Ling HUANG, Chih-Yi LI, Jui-Tzu CHANG (TWN)
- P 126. Reduce gynecology ward nurses shift meeting time in a general hospital**
I-Lu LI, Shu-Chen WANG, Ming-Chuan KUO (TWN)
- P 127. Use workplace resilience to reduce the turnover rate of intensive care unit nurses**
Yueh-Wen KAO, Yi-Hsuan CHEN, An-Na TENG (TWN)
- P 128. The innovative Care-Mediator Team promotes workplace health and changes organizational culture in a Taiwan hospital.**
Hsiu-Nan TSAI, Chun-Huang LAI, Wen-Der LAI, Shu-Fen CHIANG, Chi-Chen HUANG, Shu-Lin CHEN (TWN)
- P 129. Effect of Applying Chronic Disease Management on Workplace Health Promotion.**
Wei-Ling HUANG, Ying-Chen CHEN, Yi-Hsuan CHANG, Shou-Yung HUANG, Yi-Fang CHENG (TWN)
- P1.9 Improving the physical health of staff**
Venue: Sala Maggiore, second floor
- P 130. Efficacy and Effectiveness of Safety-engineered devices for preventing needle-stick injuries and body fluid exposure at a Medical Center**
Shu-Fen CHIEN, Hsuan-Yin MA, Ju-Chun LO, Yu-Ling LAI, Jann-Tay WANG, Wang-Huei SHENG, Yee-Chun CHEN, Shan-Chwen CHANG (TWN)
- P 131. Promoting Health of Healthcare Workers through Initiating Exercise Intervention**
Jung-Ying HOU, Ching-Fang TSAI, Paul HUANG, Jian-Yu WANG, Cheng-Wei WANG, Shan-Ching HUNG, Wei CHEN (TWN)
- P 132. Preliminary Investigation of the Effectiveness of Using Different Health Management Methods on Weight Control - A Case Study of a Southern District Hospital**
Chien-Chi CHOU, Jung-Hua HSUEH, Kun-Ling WU (TWN)
- P 133. Analysis on the Blood Glucose Detection Data of a Taiwanese's Chemical Factory Staff and Follow-up Health Promotion Management**
Meng-Szu LEE, Yu-Hsuan TANG, Ming-Lun YEH, Hsiang- Ju KUO, Jeng- Fu YANG, Shu-Ching LIN, Yu-Kuei HSU, Chia-Yen DAI (TWN)

PROGRAM DETAILS

THURSDAY, June 7, 2018

- P 134. The Relationship Between Physical Fitness and Sleep Quality in a Taiwan Eastern Regional Teaching Hospital: A Case Study on Mennonite Christian Hospital**
Chien-Ju CHEN, Yea-Pyng LIN, Wan-Hsin CHEN, Tsung-Yu CHAN, Chih-Yao LIN (TWN)
- P 135. Master Baker-Whole Grain Baking Competition**
Hui Wern KHAW, Ya Hui LEW, Teik Kee NG (MYS)
- P 136. Ergonomics Hazards Analysis and Improvement Design of Module Picking material work in Hospital Central Storage**
Chiang Fen LIU, Fang Chi CHEN, Yu The SU, Huan Chu CHEN (TWN)
- P 137. Is Weight Loss Competition Program a Healthy Way to Control Body Weight? : Workplace Health Promotion Program**
Hsiang-Ju PAN, Pei-Ju WEN, Li-Ju HUNG, Jin-Shiung CHENG (TWN)
- P 138. To Stimulate Employee Motivation to Improve Body Fat Percentage through Colleague's Encouragement and Companionship**
Ying-Hsiang WU (TWN)
- P 139. The Mobilisation Initiative to decrease sick leave in healthcare personnel**
Marga BRISMAN, Artur TENENBAUM, Louise AHLGREN, Stefan ANDERSSON (SWE)
- P 140. Effects of Exercise Program on Improving Work-related Stress in Overweight Employees in High-tech Industries**
Mei-Chi HSU, Yun-Ya FANG, Chien-Yuan HUANG (TWN)
- P 141. Improve Staff's Capability of Home-Made Diet by Holding Cookery Course and Recording Cook Video**
Pei-Ju HUANG, Pei-Jyun CHEN, Yu-Ting NIEN, Li-Ya CHEN, Yi-Fang TSAI, I-Ling HUANG, Wan-Chin CHEN (TWN)
- P 142. Ergonomics analysis of work-related musculoskeletal disorders for workplace improvement of Central Sterile Supply Department in Taipei Tzu Chi Hospital**
Li-Hua LIN (TWN)
- P 143. Cardiovascular risk assessment of hospital employees**
Ru-Yi CHEN, Fu-Wei WANG, Hao-Yu YANG, Chan-Yin TZOU, Jin-Shiung CHENG (TWN)
- P 144. The Relationship Between the Locomotive Syndrome in Staffs and Exercise Habits Before and After Adulthood.**
Gaku SUZUKI, Kaori TERAOKA, Risa WATANABE, Kyota NEGISHI (JPN)
- P 145. Preventing lower back pain in our hospital**
Narumi MURAKAMI, Toh Yoon Ezekiel WONG, Takako SUGA, Junko TATEISHI, Hirohiko MURATA (JPN)
- P 146. Satisfaction Survey of Vegetarian Meal in Work Environment**
Wen-Hsin CHIU, Yu-Fang LIN, Zhe-Wei ZHOU, I-Liang HUANG, Shih-Ching KUO, Jing-Hui WU (TWN)
- P 147. The formal use in hospital. a preventive control path in the light of the new**

PROGRAM DETAILS

THURSDAY, June 7, 2018

hazardous reclassification

Carluccio TORTI , Gian Carlo SCARPINI , Elisa SOTTOTETTI (ITA)

- P 148. The Study about the Effectiveness of Smartphone Application as Employees in Seoul National University Bundang Hospital (SNUBH)**
Kiheon LEE , Sukwon PARK, Eunhee CHOI (KOR)

- P 149. Let's Reduce Intake of Free Sugars For Health.**
Sukwon PARK, Kiheon LEE , Eunhee CHOI (KOR)

- P 150. Managing Metabolic Syndrome through Life Habit Improvement and Exercise in Workplace**
Kyuri PARK, Hanna KIM, Musang JANG, Subae LEE, Kiboung HYUN, Jong-Yil CHAI (KOR)

- P 151. Dietary Promotion Strategy Approach to Improve Iron Status in Premenopausal Hospital Women Staff**
Chiu-Ping HSU, Huang-Yu CHANG, Hsueh-Chien CHENG, Lin-Hui LI, Yu-Wen LIN, Nan-Ping YANG, Ching-Feng LIN (TWN)

- P 152. Workplace Health Promotion – Join and Fight Body fat Together**
Yu-I FAN, Ren-Shi SHYU, Xiao-Jun CHEN, Chun-Yu KE, Yi-Wen WANG, Ying-Chih CHEN, Yi-Lien LIU (TWN)

- P 153. BMI change on the development of Metabolic Syndrome after 5 years in employees of semiconductor manufacturing company**
Hon-I CHEN, Ru-Yi CHEN, Tzu-Ya HUANG, Fu-Wei WANG, Jin-Shiung CHENG (TWN)

- P 154. The effects of Exercise Intervention and health promotion for shift nurses staff in Taipei TzuChi Hospital chest wards**
Chihyi CHEN, Shunting HUANG, Hsiao Jen HUANG (TWN)

P1.10 Monitoring and implementation of health promoting strategies and standards

Venue: Sala Maggiore, second floor

- P 155. Health Promotion in Military University Hospital Prague**
Lenka GUTOVA, Monika VANHOVA (CZE)

- P 156. Evaluating The Implementation of WHO Health Promotion Hospital Advanced Certification Program**
Ya-Hsueh HUANG, Hsin-Yi YANG, Chieh-Hsiang LU, Tsai-Sung TAI, Fang-Ping KUNG, Hui-I YU (TWN)

- P 157. Self assessment on HPH Standards of ASL Roma 1 (Italy)**
Claudio LAZZARI, Maddalena QUINTILI, Daniele GAMBERALE (ITA)

- P 158. Efforts to Continue Clinical Health Promotion after HPH recognition project**
Keiko TAKAHASHI, Mayumi INAMURA, Naho OTANI, Junichiro YOSHIOKA, Isao FUKUBA (JPN)

- P 159. Promote Comprehensive Patient-Centered Medical Care with Health Promoting**

PROGRAM DETAILS

THURSDAY, June 7, 2018

Hospitals Accreditation (HPH) and Integrated Chronic Care Health Promotion Model, (ICCHPM). - A Case Study of A Medical Center in Southern Taiwan.

Ling-Sui CHEN, Wei-Ling HUANG, Chia Wen HSU, Chia-Fang CHANG, Hui-Chen CHEN (TWN)

P 160. Applying RE-AIM framework to access the impact of health promoting hospital on hospital employees: the Taiwan experience

Shu Li CHIA, Dih-Ling LUH, Chien-Yu LAI, Chine-Ming CHOU, Yung-Hung CHANG (TWN)

P1.11 Pain-free health care

Venue: Sala Maggiore, second floor

P 161. Physiological effect of touch intervene in palliative patient compare to Orange Sweet Oil

Ting-Feng YANG, Chun-Lan LIN, Chia-Yen HO (TWN)

P 162. Family Meeting for Hospice and Palliative Care: The Improves Do-Not-Resuscitation Consent Signature in p't with Chronic MV Care

Kuei-Ling HSU, Hsueh-Ping TAI, Chiu-Fan Chen, David Lin Lee, Kang-Pan CHEN, Jin-Shiung CHENG (TWN)

P 163. Breakthrough cancer pain: characteristics, management and impact on the quality of life of hospitalized patients

Maria DO CARMO FERREIRA-SANTOS, Rosa SUÑER-SOLER, Rut PORTA, Walter CARBAJAL, Dolors JUVINYÀ (ESP)

P 164. Effects of Intravenous Vitamin C on Pain Relief: Meta-Analysis of Randomized Controlled trials

Yi-Chun CHEN, Yuh-Wen SU, Ching-Ching PENG, Yeu-Tyng LIN, Wu-Hsiung CHIEN, Shu-Ching HSUEH, Tao-Hsin TUNG, Shih-Min HSIA (TWN)

P 165. The effects of auricular acupressure on pain, anxiety and blood pressure for patients after arthroscopic surgery of shoulder

Jhih-Yu LIN, Shuo-Suei HUNG, Kuen-Huei LIN, Pei-Ching WU (TWN)

P1.12 Promoting the health of children and adolescents

Venue: Sala Maggiore, second floor

P 166. Specchio Riflesso: A new creative intervention to prevent smoking behaviour in early adolescence

Patrizia STECA, Marco D'ADDARIO, Alessio GAMBA, Dario MONZANI, Daniela GIANGRECO, Luca DE LUCIA, Marco ALLOISIO, Roberta BASSO (ITA)

P 167. School project about prevention of alcohol consumption between teenagers from 15 to 17 years old.

Mattia SCIPIONI, Carmela FRANCHELLA, Pierangela ANTONECCHIA, Angela FERRARA, Marinangela BELLOMO, Marianna D'AULERIO, Barbara SBROLLA, Giovanni FABRIZIO, Salvatore FRANCIONE (ITA)

P 168. Effectiveness of Health Knowledge Integration into Children 's Summer Camp - A Case Study of Taiwan.

Yi-Hsuan LIN, Shih-Yu YEH (TWN)

PROGRAM DETAILS

THURSDAY, June 7, 2018

- P 169. Assess the fall risk among hospitalized pediatric patient**
Yu-Ling CHEN, Er-Mei CHEN, Ching-Feng LIN (TWN)
- P 170. Current status of Oil Disease children in Taiwan, A 14-years Study of 176 Cases in Taiwan**
Jung-Hua HSUEH, Yuan-Tsung TSENG (TWN)
- P 171. Prevalence of Chronic Hepatitis B Carriers among Junior High School Students in South Taiwan**
Jih-Kuei YEH, Chia-Hui CHEN (TWN)
- P 172. Prevalence of Overweight and Obesity among Junior High School Students in South Taiwan**
Jih-Kuei YEH, Chia-Hui CHEN (TWN)
- P 173. Sharing the Results of Improving Children Household Safety -In a Remote Area in Southern Taiwan.**
Mei-Hui WU, Bie-Ching LIU, Yu-Wen CHEN (TWN)
- P 174. Implementation of Fever Education and Treatment Flowchart to Reduce Discharged Pediatric Patients Return Visit Rate in Emergency Department Within 72 Hours**
Chih-Jung KUO, Shu-Mei LIN, Kuan-Hung LIN (TWN)
- P 175. The Global Health Promotion Strategies for Indonesian Children: Evidence-Based Practices through Cooperation between Health Promoting Hospitals in Korea and Indonesian Civil Society Organization**
Eunjoo KWON, Eun-Hee NAH, Seon CHO, Heon-Woo JEONG, Jin-Youp RYU, Hyun-Seung KIM, Keon-Hoon LEE, Hoo-Gn JEOUNG, Eui-Hyug HOANG (KOR)
- P 176. Outcome of Newborn Glucose-6-Phosphate Dehydrogenase (G6PD) Screening Program in Taiwan**
Kwang-Jen HSIAO, Hsin-Ling YEH, Yu-Shih SHIAU, Pei-Chen TSAO, Szu-Hui CHIANG, Po-Huang CHIANG, Ying-Wei WANG (TWN)
- P 177. Use the game-turntable to perform aerosol therapy to reduce the number of hospital stays for sick children with respiratory illnesses**
Tzu-Wei TSENG, Hsiang-Ying HUNG, Shu-Chuan CHIANG, Mei-Chuan WU (TWN)
- P 178. Specific learning disorders: work in progress**
Luigina CENCI, Lina ROSSI, Giulia FRASCIONE, Cindy FRASCIONE, Pamela APPOLONI, Irene Di FRANCESCANTONIO, Agnese ZAMMIT (ITA)
- P 179. The Influence of Using Musical Group Activities on Adolescents' Self-concept - take Taiwan Wulai indigenous adolescents for example**
Chung-Feng WENG, Yi-Hui LIN, Chun-Han TSENG, Hung-Yu HSIEH, Hsin-Chun CHEN, Tong-Yun HSIAO, Shih-Yun CHIEN, Yu-Shan HUNG (TWN)
- P 180. Developmental Outcome in Infant with Esophagus Atresia and Tracheoesophageal Fistula: Case Study**
Tzu-Hsiu HUANG, Yun-Hue JU, Su LEE, Hsiu-Lin CHEN (TWN)

PROGRAM DETAILS

THURSDAY, June 7, 2018

- P 181. Achievement Sharing of Cambodian Children Health Care Project**
Fan Yun SHEN, Wei Chun HUANG, Jin Shiung CHENG, Hong Tai CHANG,
Yee Hsuan CHIOU, Wan Sheng LIU, Pi Chuan WU, Yen Ting LIN, Li Fei PAN (TWN)
- P 182. A Multidisciplinary Approach to Reduce the Intestinal Parasitic Infection Rates among Schoolchildren~ A 5 Years of Rooting Experiences by Taiwan in Two Remote Community Schools of Solomon Islands**
Wei-Chou CHANG, June-Der Lee, Jiun-Jye Wang, Hui-Yu Hsu, Yu-Chau Lin, Meng-Chuan Huang, Cheng-Jye Jeng, Inn-Wen Chong (TWN)
- P 183. Why does it smoke? Prevention intervention on cognitions with respect to smoking in pre-adolescence**
Rita CORAZZA, Daniel Lina MANCUSO (ITA)
- P 184. The Effects of Adolescent Internet Usage on School Life Adaptation – Base on a Junior College of Nursing**
Lih Lih CHOU, Hsiao Fen LIU, Wei Chu WANG (TWN)
- P 185. Combat poor nutrition! Diminish overuse injuries! What we do for community adolescent athletes**
Shiau-Fu HSIEH, Yu-Shu CHIOU (TWN)
- P 186. Forming Interdisciplinarity & Community Healthcare Network for Adolescent Athletes**
Shiau-Fu HSIEH, Tzu-Han WANG (TWN)
- P 187. Effectiveness of high-fidelity simulation training to improve the skills and clinical management of fetal monitoring for obstetric nurses**
Hsiu-Lan LEE, Yi-Hao WENG, Pei-Chi LIU
- P1.13 Promoting the health of pregnant women and mothers**
Venue: Sala Maggiore, second floor
- P 188. The usefulness of multiple information sources for an optimal surveillance of miscarriage at the population level**
Riccardo PERTILE, Mariangela PEDRON, Silvano PIFFER (ITA)
- P 189. Evaluate the effectiveness of intervention program for second-hand smoking cessation during pregnancy**
Mung Jung LEE, Ron Yuan HSU, Cheng Yu CHEN, Hsin LU (TWN)
- P 190. Application of Perineal Warm Packs on Labor Pain and Comfort in the Second Stage of Labor**
Mu-Jung CHIU, Meei-Ling GAU, Pei-Ying LIN, Shu-Mei LIN, Tzu-Chuan HSU,
Hui-Ting HUANG (TWN)
- P 191. Regulations and policy in regulating aspects of ART-related multiple-birth in Taiwan**
Ying-Wei WANG, Miauh-Shin CHEN (TWN)
- P 192. From the Outsider to the Insider: A Narrative Inquiry on Breastfeeding Experiences of a Female Surgical Physician**
Wan-Ting HUANG, Hsin-Yi YANG, Yu-Chen HSU, Li-Chen CHANG (TWN)

PROGRAM DETAILS

THURSDAY, June 7, 2018

- P 193. Nutritional status of pregnant women in Taipei Tzu Chi Hospital**
Chang-An TSAO, Yi-Cheng HOU, Yin-Kuang CHANG, Chyi-Huey BAI, Neng-Hsin CHENG, Li-Chu LEE, Yu-Ling HSIEH (TWN)
- P 194. Using of Maternal and Child Health Record with Nutritional Status and Childhood Development in Thailand**
Siriporn JARIYAJIRAWATTANA, Wannapa KANGKAN, Nuchjarin POONSAWAT, Panit LOSATIANKIT (THA)
- P 195. Evaluate Effectiveness of Smoking Cessation Intervention Program for Smokers Living with Pregnant Women**
Cheng-Yu CHEN, Hsin LU, Mung-Jung LEE, Ron-Yuan HSU, Ching-Fen HSU (TWN)
- P 196. The Differences of The Night Sleep Quality Between Rooming-in and conventional postpartum women**
Mung-Jung LEE, Meei-Ling GAU (TWN)
- P 197. Pre-pregnancy body mass index and gestational weight gain and their effects on pregnancy and birth outcomes in Taiwanese women**
Hsin-Yi YANG, Solomon Chih-Cheng CHEN, An-Ting LEE, Wei CHEN (TWN)
- P 198. Lectures to Grandparents “Welcome, my grandchild” For Happiness across Three Generations**
Mika ANDO, Chihiro ETO, Giichiro OHNO (JPN)
- P 199. Prescription patterns and consequences of Chinese herbal medicine in pregnant women: A population-based study**
Hsien-Chang WU, Dai-Lun WU, Shu-Hui WEN (TWN)
- P1.12 Promoting the health of children and adolescents**
Venue: Sala Maggiore, second floor
- P 200. Evaluate the Effect of Critical Values Notification and Audit System to Enhance Patient Safety**
Chi-Chao TU, Pei-Ning LEE, Tung-Huan WU, Meng-Ting WU, Yu-Wen LIN, Nan-Ping YANG, Ching-Feng LIN (TWN)
- P 201. Collecting Intravenous Drip Stands by an Innovative Cabinet to Improve Clinical Care**
Bey-Jing YANG, Jiann-Fu LIN (TWN)
- P 202. Reduction of central-line associated bloodstream infection after implementation of care bundle: a multidisciplinary approach**
Ching-Min HUANG, Shu-Chuan WANG, Pei-Chen SU, Hsiao-Wen TSAI (TWN)
- P 203. Chest Physiotherapy and Care of Pneumonia in the Elderly**
Mei-Hua WANG, Ping-Huai WANG, Hou-Tai CHANG (TWN)
- P 204. A 15-year continuous quality improvement can reduce unplanned extubations in adult intensive care units.**
Mei-Lin YEH, Wei-Chun HUANG, Kang-Pan CHEN, Ya-Meei LUE, Hsing-Chi CHUNG,

PROGRAM DETAILS

THURSDAY, June 7, 2018

Shu-Hung KUO, Kun-Chang LIN, Wang-Ting HUNG, Sheng-Che LIN,
Chin-Chang CHENG, Shue-Ren WANN, Chun-Peng LIU, Jin-Shiung CHENG (TWN)

- P 205. Reducing the incidence of falls for the inpatient population**
Jia-Min WU, Ya-Hui CHEN, Ching-Mei CHANG, Ying-Zheng CHEN, Zhi-Quan HSU,
Hui-Jen CHEN, Chun-Lai HONG, Chen-Jung YEN, Hung-Yi HSU (TWN)
- P 206. A new system to reduce the incidence of cardiac arrest in cardiology wards - Early Warning Systems**
Kuei-Hsien YANG, Truey-Yeh SONG (TWN)
- P 207. Application of Bundle Care to Reduce respirator related contract pneumonia Infections**
Ya Meei LUE, Hsia Fen YANG, Kang Pan CHEN, Jin Shiung CHENG (TWN)
- P 208. Clinical health promotion in complex patient pathways.**
Susanne VAHR LAURIDSEN, Bente THOFT JENSEN (SWE)
- P 209. Evaluation of Pharmacist's Intervention on Interprofessional Practice for Home Health Care**
Chih-Wun FANG (TWN)
- P 210. Effectiveness of reducing pressure injury incidence if using air cushion bed and changing position every 2 or 3 hours**
Sung-Yun CHEN, Shih-Fang YANG, Yi-Fan TSAI (TWN)
- P 211. Use bladder ultrasound to limit unnecessary re-insertion of urinary catheter and thus to reduce catheter-associated urinary tract infections.**
Hsing-Chi CHUNG, Ming-Shiuan HUANG, Jui-Kuang CHEN, Yun-Yu WU, Kang-Pan CHEN,
Jin-Shiung CHENG (TWN)
- P 212. The Improvement for Inpatients Fall Prevention**
Chia-Chen CHANG, Chiou-Yu WU, YI-Shan LAI, Pei-Jung LI, Ming-Chu FENG (TWN)
- P 213. Decrease the complication of cancer inpatient with PICC**
Fang-Ying CHIANG, Chi-Chen HSU, Wan-Zhen YANG, Tung-Yun WU, Shu-Ting CHUANG,
Sou-Hsin CHIEN (TWN)
- P 214. The 5-year continuous quality improvement program can reduce in-hospital cardiac arrest via early warning information system**
Shu-Hung KUO, Wei-Chun HUANG, Wang-Chuan JUAN, Kun-Chang LIN, Wang-Ting HUNG,
Cheng-Hung CHIANG, Sheng-Che LIN, Chin-Chang CHENG, Po Hsiang LIN, Guang-Yuan
MAR, Shue-Ren WANN, Yao-Shen CHEN, Chun-Peng LIU, Jin-Shiung CHENG (TWN)
- P 215. Improvement of Healthcare-association Bloodstream Infection in Hemodialysis Outpatients at a Medical Center Unit**
J.-C. LO, H.-C. LIN, W.-H. SHENG, Y.-C. CHEN (TWN)
- P 216. Improving Magnetic Resonance Imaging Test Completion Rate**
Chuan-Yu LIN, Hung-En WEI, Ping-Chang HSIEH, Yu-Wen LIN, Nan-Ping YANG,
Ching-Feng LIN (TWN)

PROGRAM DETAILS

THURSDAY, June 7, 2018

- P 217. Factors Influencing Inpatient Medication Errors: An Analysis of the Medical Incident Reporting System**
Ju-Fang WU, Shu-Lin CHEN, Chieh-Fan CHEN, Wen-Ter LA (TWN)
- P 218. The investigations of Hospital Services and Patients' Loyalty - Using a Regional Teaching Hospital in Northern Taiwan as an Example**
Chi-Wen WU, Yu-Wen LIN, Nan-Ping YANG, Ching-Feng LIN (TWN)
- P 219. Project for Reducing the Amount of Overtime Worked by Paramedics in Medicine Departments**
Ya-Hui HUANG, Jin-Shiung CHENG (TWN)
- P 220. Hospital staff on the Legionnaires' disease Knowledge, attitude and behavior survey**
Hung-An HSIEH, Meng-Tsung CHENG (TWN)
- P 221. The Association between the Development of Pressure Injury and the Operative Positioning in a Medical Center: a Cohort Study.**
Shu-Ling WANG, Fu-Lien CHUANG, Li-Hua LIN, Shing-Fen WU, Yi-Chen TANG, Jin-Shiung CHENG (TWN)
- P 222. Analysis and Research on 2017 Abnormal Incidents in the Department Pharmacy of Pharmacy-Using a Regional Teaching Hospital in Northern Taiwan as an Example**
Po-Jen SHIH, Yu-Wen LIN, Nan-Ping YANG, Ching-Feng LIN (TWN)
- P 223. A model to manage rehabilitation need after orthopedic discharge**
Maria Teresa MARTINO, Emiliano VARALDA, Carolina BONA, Francesco REITANO, Luca ABATANGELO (ITA)
- P 224. Prescriptive appropriateness of orthopedic, physiatric, rheumatological, neurosurgical visits and of NSAIDs in the elderly patient**
Bettina MARCONI, Irene PROSCIA, Mario PALAZZI, Eleonora FERRETTI, Filippo PISI, Lorenzo FERRARI, Sara FANTUZZI, Rossella RODOLFI, Maria Beatrice BASSI, Samanta VALERIANI, Claudio FERRAÙ, Sonia GUALTIERI, Mirco PINOTTI, Corrado BUSANI, Laura GABRIELLI (ITA)
- P 225. Peer comparison in order to improve the prescriptive appropriateness in pediatrics**
Rita MONTANARI, Romano MANZOTTI, Paolo Giorgi ROSSI, Pamela MANCUSO, Mirco PINOTTI, Laura GABRIELLI (ITA)
- P 226. Patient safety in real time**
Eva-Karin ELKJAER (SWE)
- P 227. Evaluating the Effectiveness of Fall Risk Screening Tool to identify the fall risk factors in acute care hospital**
Hui-Fen HSING, In-Fun LI, Shih-Chia CHEN, Shu-Chuan LIN, Ta-Chuan HUNG (TWN)
- P 228. Exploring the Inpatient Fall Incidence Factors in Psychiatric Center Southern of Taiwan**
Shu-Min CHANG, Huei-Lan LU (TWN)
- P 229. Using a question prompt list as communication aid to increase patient participation during consultation in general practice**
Mi-Hsiu WEI, Ying-Wei WANG, Mei-Chuan CHANG, Jyh-Gang HSIEH (TWN)

PROGRAM DETAILS

FRIDAY, June 8, 2018

09:00-10:30 Plenary 4

Co-producing better health gain by user participation and community involvement

Venue: Palazzo della cultura e dei congressi, Room Europa Auditorium
Chairs: Bożena WALEWSKA-ZIELECKA (POL), Giulio FORNERO (ITA)

Patient centered collaboration: involving patients and families in health care

Carlo DI CLEMENTE, Department of Psychology, University of Maryland, Baltimore County (USA)

The role and contributions of self-help groups and the self-help-friendly hospital

Alf TROJAN, Institute for Medical Sociology, University Medical Center Hamburg-Eppendorf (DEU)

Our six core strategic goals as defined in the 2014-2020 strategic planning

Marco GRECO, Chairman, European Patients Forum, Brussels (BEL)

The development and implementation of the Italian Regional Program on Health Literacy

Rima RUDD, Department of Social And Behavioral Sciences, Harvard T.H. Chan School of Public Health, Boston (USA)

16:00-17:00 Plenary 5

Strengthening health promotion and disease prevention in primary health services

Venue: Palazzo della cultura e dei congressi, Room Europa Auditorium
Chairs: Alan SIU (HKG), Antonio BRAMBILLA (ITA)

European policies for integrating public health in primary health care

Anna Cichowska Myrup, Programme Manager, Public Health Services (PHS), Division of Health Systems and Public Health, WHO Regional Office for Europe

The role of primary health care in disease prevention and health promotion

Stephen PECKHAM, Director, Centre for Health Services Studies, University of Kent (GBR)

Bridging the gap between public health and primary care: experiences from the Netherlands

Pim ASSENDELFT, Professor of General Practice Medicine, Faculty of Medical Sciences, Radboud University, Nijmegen (NLD)

PROGRAM DETAILS

FRIDAY, June 8, 2018

11:00-12:30 Oral sessions 3

O3.1 Integrated health care services and discharge planning

Venue: Sala Maggiore, Celeste Room
Chair: Margareta KRISTENSON (SWE)

Early Comprehensive Survey Combined with Active Intervention in Elderly Medical Inpatients Will Decrease the Hospital Stay and Re-Admission Rate

Weiman KAN, Shu-Fen CHI, Tzu-Hsin HUANG, Yu-Sheng LIN (TWN)

Gapless Long-term Healthcare: Quick Response Home-Based Rehabilitation Service to Increase Physical Activity and Improve Function after Hospitalization

Chun-Chieh WU, Mu-Jung KAO (TWN)

Seamless discharge planning service

Meng Ping WU, Rung Chuang FENG, Lee Ing TSAO, Shih Chen YANG, I Chen CHU, Shu Ping CHOU, Wen Chuan LU, Mei Ling HUANG, Sheng Jean HUANG (TWN)

Longterm effectiveness of discharge planning service

Ku-Chou CHANG, Shu-Ting JIANG, Ting-Wen CHEN, Hsiu-Min CHEN (TWN)

O3.2 Promoting physical activity

Venue: Sala Maggiore, Rossa Room
Chair: Astrid LOIDOLT (AUT)

Regional strategy to promote physical activity - using a combined top-down and bottom-up approach, from policy to action on grass root' level using social media

Matti LEIJON, Anna-Karin SCHÖLD, Elin GLAD (SWE)

Adapted Physical Activity network in Reggio Emilia between 2011 and 2017: promoting healthy lifestyle for people dealing with chronic conditions

Stefania FUGAZZARO, Alena FIOCCHI, Evelyn IOTTI, Isidoro MALVAROSA, Claudio TEDESCHI (ITA)

Empowering of patients, families and citizens in partnering with their associations for the implementation of physical activity promotion

Giulio FORNERO, Elisa CARENA, Giovanni CICCONE, Alda COSOLA, Anna DE LUCA, Eva PAGANO, Ida Marina RACITI, Claudio ZIGNIN (ITA)

Community-Based Fitness Training Program: Effects of a 12-week Intervention in Frail and Sub-healthy Elderly

Huei-Chin HUANG, Shew-Meei SHEU, Ching-Fang TSAI, Chun-Yi WU, Jian-Yu WANG, Jung-Ying HOU, Wei CHEN (TWN)

Cross-sectional relationships between television viewing and physical fitness in older adults

Jung-Ying HOU, Ching-Fang TSAI, Jian-Yu WANG, Cheng-Wei WANG, Shan-Ching HUNG, Pei-Lin WU, Wei CHEN, Cheng-Wei WAN (TWN)

PROGRAM DETAILS

FRIDAY, June 8, 2018

Using Pedometer to Monitoring and Increasing Physical Activity among Overweight Children – The Taitung School Children Program
Nain-Feng CHU, Hong-Lien WU, Ying-Ching LIN (TWN)

O3.3 Tobacco free health services

Venue: Palazzo della cultura e dei congressi, Bologna Room
Chair: Ragnhild SPILKER (NOR)

A total non-smoking health care in Region Östergötland, Sweden
Anna-Karin SCHÖLD, Elin GLAD, Alexandra WHITE, Matti LEIJON (SWE)

A breath of fresh air. Leading the way in the smokefree journey
Emma DEAN, Linda BRADFORD, Kia NOBLE (AUS)

Trends in Smoking Prevalence and attitudes to a hospital campus smoking ban among hospital inpatients 2010-2016
Ailsa LYONS, Eimear BURKE, Justine NABWIRE, Kirsten DOHERTY, Laura KINSELLA, Sinead STYNES, Elaine CUNNIFFE, Emer CASHMAN, Daniella OLUBODE, Leslie DALY, Cecily KELLEHER, Patricia FITZPATRICK (IRL)

Efficacy of a smoke-free workplace program for the promotion of smoking cessation among employees
Hyekyeong KIM, Kwang Kee KIM, Jeonghoon AHN, Jakyoung LEE, Eunhee NAH, Jung JEKARL, Norma P RODRIGUEZ ROCHA, Ji-Eun LEE, Hyeyun KIM, Jiwan KANG, Jeongeun LEE, Jaeun LEE (KOR)

Prevalence and Trends of Cigarette Smoking among Military Personnel in Taiwan -- Results of Ten-Year Anti-Smoking Health Promotion Programs in Military
Nain-Feng CHU, Fu-Huang LIN (TWN)

O3.4 Health literacy

Venue: Sala Maggiore, Indaco Room
Chair: Eva LEUPRECHT (AUT)

Fire and Fury in an Internal Medicine Ward: how Health Literacy (HL) and Communication Skills can stamp out the Flames
Alberto BAGNULO, Claudia GAIONI, Ivanna GASPARINI, Alessandra ZOBOLI (ITA)

Right word. Right time: compelling health professionals to raise preventive health
Kia NOBLE, Gemma SMOKER, Emma DEAN (AUS)

The level of self-rated knowledge among the patients with early rheumatoid arthritis in Estonia: 2-years follow-up
Kaja PÖLLUSTE, Raili MÜLLER, Riina KALLIKORM, Margus LEMBER (EST)

An Italian therapeutic patients education program to support self-management in stroke survivors: feasibility and results
Stefania FUGAZZARO, Roberta BARDELLI, Monia Allisen ACCOGLI, Monica DENTI, Alessandra ALTAVILLA, Enrica CAVALLI, Paolo GHERARDI, Piera CLERICI, Manuela FAENZA, Laura DALLOLIO, Paola RUCCI, Donatella PAGLIACCI, Simona CALUGI, Stefano CAVAZZA, Claudio TEDESCHI, Mariangela TARICCO (ITA)

PROGRAM DETAILS

FRIDAY, June 8, 2018

Text editing and provision of healthcare information according to Health Literacy (HL)

Federica GAZZOTTI, Valentina BEDOGNI (ITA)

O3.5 HPH Standards

Venue: Sala Maggiore, Magenta B Room

Chair: Manel SANTINÀ (ESP)

The meaning and realization of equitable healthcare services in Finnish healthcare unit – the viewpoints of healthcare leaders, nurses and immigrant parents described using TF MFCCH equity standards. A study protocol.

Hanna KAMPPILA (FIN)

The implementation of Healthy Hospital Accreditation in Taiwan

Chia-Chen LIN, Hui-Ting HUANG, Jin-Ding LIN, Lee-Ching HWANG, Chia-Fen WANG, Po-Shan CHIEN, Ying-Wei WANG (TWN)

Development and Validation of Self-Assessment Tool for Health Promoting Hospitals in Iran based on WHO's Tool

Mohammad-Hossein VAZIRI, Nastaran Keshavarz MOHAMMADI, Ali RAMEZANKHANI, Amir KAVOUSHI, Alireza OLYAEEMANESH (IRN)

Health Promoting Hospital standards: Results of a study in Iran

Nastaran Keshavarz MOHAMMADI, Mohammad-Hossein VAZIRI, Ali RAMEZANKHANI, Amir KAVOUSHI (IRN)

Fast-track strategic implementation of clinical health promotion and examples of reporting using the RE-AIM Framework

Jeff Kirk SVANE, Hanne TØNNESEN (DNK)

Staff experiences with strategic implementation of clinical health promotion: A nested qualitative study

Jeff Kirk SVANE, Ingrid EGEROD, Hanne TØNNESEN (DNK)

O3.6 User participation and empowerment

Venue: Palazzo della cultura e dei congressi, Bianca Room

Chairs: Hans VERREPT (BEL)

Informed consent and empowerment

Pietro RAGNI, Ludovica DE PANFILIS, Giorgio GUALANDRI, Federica GAZZOTTI, Antonia NINI, Matteo ZANICHELLI, Gianni BINELLI, Valentina CHIESA, Antonino CHIARENZA, Cristina MARCHESI (ITA)

The relation between patient education, patient empowerment and patient satisfaction

Tao-Hsin TUNG, Mei-Yu YEH, Shu-Chen WU (CHN)

Patient Experience, Partnerships and Participation: Improving communication and collaboration

Marie SERDYNKA, Karine VIGNEAULT, Danielle LAMY, Seeta RAMDASS, Amy MA (CAN)

Committee for community health promotion: Enhancing the development and application of community health literacy

Ta-Chuan HUNG, Ching-Yao WEI, Tsu-Hsueh HUANG (TWN)

PROGRAM DETAILS

FRIDAY, June 8, 2018

Advocating for Roma Health Equity in at At-Risk Local Context

Manuel GARCIA-RAMIREZ, Daniela MIRANDA, Fabricio BALCAZAR, Yolanda Suarez-BALCAZAR (ESP)

Opinions and attitudes of Patients' Autonomy Act among medical staff

Chun-Kai FANG (TWN)

O3.7 Targeting chronic conditions

Venue: Sala Maggiore, Rossa Room A

Chair: Diane LEVIN-ZAMIR (ISR)

Creating a "culture of exercise" within the dialysis unit by implementation of intradialytic physical training as a standard of care

Karen BRONNER, Danny ZALEWSKI, Itai GOLDFARB, Naama CONSTANTINI, Jayson RAPOPORT (ISR)

Therapeutic patients education program in addition to physical activity to engage onco-heamatological patients in managing cancer-related fatigue

Monia Allisen ACCOGLI, Monica DENTI, Stefania COSTI, Stefania FUGAZZARO (ITA)

Effectiveness of Vitamin D Supplementation in the Relief of Dysmenorrhea: Meta-Analysis of Randomized Controlled Trials

Yi-Chun CHEN, Yuh-Wen SU, Ching-Ching PENG, Yeu-Tyng LIN, Wu-Hsiung CHIEN, Shu-Ching HSUEH, Tao-Hsin TUNG, Shih-Min HSIA (TWN)

The Research of the Pain Sources, Pain Intensity, Pain Management, and Other Factors of Critically Ill Patients

Wen-Hui LU, Te-Fen LEE, Xiao-Wen GAO, Hui-Wen XU, Mei-Ling CHEN, Wan-Chen HUNG, Jing-Yu QIU, Meng-Chen LEE (TWN)

Meta-analysis of clinical trials evaluating optimal timing of postoperative showering for clean and clean-contaminated wounds

Chin-I HSU, Ching-Jung LIN, Shih-Yu LEE, Pei-Chin LIN, Jin-Shiung CHENG (TWN)

O3.8 Mental health

Venue: Sala Maggiore, Rossa Room B

Chairs: Peter CHUK (HKG)

Psychological Vulnerability in asylum seekers and refugees: a network answer in Reggio Emilia

Francesca BONVICINI, Lucia MONICI, Marina GRECI, Benedetta RIBOLDI, Rossano FORNACIARI, Marco TREVIA, Piera BEVOLO, Angela MAZZOCCHI, Marco AICARDI, Loverci DE MORAES, Nicolò DEGL'INCERTI TOCCI, Marcella LATROFA, Lara TAGLIAVINI, Antonio CHIARENZA (ITA)

Assessing e-mental health use and needs among students at European universities

Rachid KHALDOUN (AUT)

Risk of Suicidality in People with Psoriasis: A Systematic Review and Meta-Analysis of Cohort Studies

Ting-Hao CHEN, Ching-Chi CHI, Shu-Hui WANG, Tao-Hsin TUNG (CHN)

PROGRAM DETAILS

FRIDAY, June 8, 2018

Training the facilitators of the BHC-5L for suicide prevention in four counties with higher suicide rates in Taiwan

Chun-Kai FANG, Hsueh-Wen HSIAO (TWN)

Late life depression and poetry recitation: the He.s.i.o.d. study (Hexameter Study In Older Depressed)

Martino BELVEDERI MURRI, Nicola PADULA, Erika NEROZZI, Alessandro CREMONINI, Luigi BAGNOLI, Donato ZOCCHI, Barbara ASSIRELLI, Carlo TACCONI, Lorenzo CHIARI, Alice CONI, Rabih CHATTAT, Salvatore SQUATRITO, Mario AMORE, Abebaw YOHANNES, Klea BERTAKIS, Maddalena DE MATTEIS, Fausto TREVISANI, Stamatula ZANETIDOU (ITA)

Using ISBAR to Construct Critical Evaluation of Emergency Triage to Improve Either the Efficiency of Emergency Physicians Communication or Efficiency of Triage by nurses

Sheng-I HSU, Huei-Lan LU (TWN)

03.9 WORKSHOP: Guidance for Health Promotion in Primary Health Care

Venue: Palazzo della cultura e dei congressi, Italia Room

Chair: Jürgen M. PELIKAN (AUT)

03.10 WORKSHOP: on People-centered Age-friendly Health Services

Venue: Sala Maggiore, Ciano Room

Chair: Shu-Ti CHIOU (TWN)

People-centered Integrated Age-friendly Health Services- a collaborative approach

Shu-Ti CHIOU (TWN)

Engaging and empowering older people & communities in and by age-friendly healthcare organizations

Wei CHEN (TWN)

Re-orienting the model of care: 1. Universal risk assessment and personalized intervention for elderly patients; 2. Care coordination and integration for elderly-centered care

Yu-Te LIN (TWN)

14:15-15:45 Oral sessions 4

04.1 ICTs to promote health

Venue: Sala Maggiore, Celeste Room

Chair: Birgit METZLER (AUT)

eAuthorization in Social- and Healthcare – New Era in eServices

Anna-Elina UKKONEN, Matti HILTUNEN, Jari SUHONEN, Virva HARTONEN, Anu SALPAKOSKI (FIN)

Co-producing solutions for digital health literacy

Bob GANN (GBR)

PROGRAM DETAILS

FRIDAY, June 8, 2018

Opportunistic multiple behaviour change counselling delivered by trained health professionals in community-based health services, workplaces, and in cancer screening settings

Sandra BOSI, Giuseppe GORINI, Cristina GOZZI, Francesca ZIRONI, Marco TAMELLI, Giovanni FORZA, Mateo AMEGLIO, Silvana WIDMANN, Eralda LICHERI, Grazia MERCATILI, Milena FRANCHELLA, Fabrizia POLO, Cristina MARCHESI, Carlo DICLEMENTE, Ermanno RONDINI (ITA)

Implementation of Self-Service Technology for Blood Pressure and Blood Sugar Management Between the Hospital and the Telecom Operator

Mei-Chuen WANG, Chun-Nan TENG, Niann-Tzyy DAI, Chang Hsun HSIEH, Niann-Tzyy DAI, Ding-Chung WU, Cheng-Yu CHEN (TWN)

Information governance facilitated the one-stop service in outpatient clinic

Liangfeng TANG, Xiaobo ZHANG, Chenjie YE (CHN)

O4.2 Alcohol - prevention and coping

Venue: Palazzo della cultura e dei congressi, Italia Room

Chair: Kaja PÖLLUSTE (EST)

Scand-Ankle – The effect of alcohol intervention regarding complications after acute ankle fracture surgery (RCT)

Julie EGHOLM, Bolette PEDERSEN, Mette RASMUSSEN, Hanne TØNNESEN, Bjørn MADSEN, Jes LAURITZEN, Johanna ADAMI (DNK)

The path to mental health and recovery begins with human rights

Inger Kari NERHEIM (NOR)

Effect of a Very Integrated Program (VIP) on consumption, health and co-morbidity in alcohol /drug addicted patients on short term: a randomised controlled trial

Karen HOVHANNISYAN, Johanna ADAMI, Hanne TØNNESEN (SWE)

Smoking and alcohol cessation intervention in relation to major bladder cancer surgery

Susanne VAHR LAURIDSEN, Thordis THOMSEN, Gudrun KALDAN, Line NOES LYDOM, Hanne TØNNESEN (SWE)

Factor analysis of abstinence intent and alcohol consumption among patients with alcohol use disorder

Chun-Kai FANG (TWN)

Taiwan National project to construct alcohol prevention network by 8 centers

Chun-Kai FANG, Pao-Wen SHIH, Chia-Hua LIN (TWN)

O4.3 WORKSHOP: The Future of Hospital in a Changing Climate: From Useful Science to Usable Practices

Venue: Palazzo della cultura e dei congressi, Bologna Room

Chair: Shu-Ti CHIOU (TWN)

The Future of Hospital in a Changing Climate: From Useful Science to Usable Practices)

Anja LEETZ, Alex CHEN, Ming-Nan LIN, Cordia CHU (BEL)

PROGRAM DETAILS

FRIDAY, June 8, 2018

O4.4 Health literate healthcare organizations

Venue: Sala Maggiore, Indaco Room

Chair: Federica GAZZOTTI (ITA)

Implementing a national policy for improving healthcare communication in Austria – Train the Trainer Programme for communication skills teaching in healthcare institutions

Peter NOWAK, Marlene SATOR (AUT)

Health Literacy Applying to Low-Economic Country to Improve Health Status - A Case Study of Nepal

Shih-Tien HSU, Hsin-Yun CHOU, Nu-Chen KUO, Chin-Hsiang LO (TWN)

Promoting health: professional expertise in supporting changes in high-risk lifestyles

Sandra BOSI, Mateo AMEGLIO, Giovanni FORZA, Cristina MARCHESI, Adriana GIANNINI, Nicoletta BERTOZZI, Antonio CHIARENZA, Francesca ZIRONI, Carlo DICLEMENTE (ITA)

Is the hospital an appropriate setting for behavioural change interventions?

Fabrizio FAGGIANO (ITA)

O4.5 Workplace health promotion

Venue: Sala Maggiore, Rossa Room A

Chair: Giulio FORNERO (ITA)

The needs for active aging courses among medical and administrative staff of an age-friendly hospital in Taiwan

Chin-Huan HUANG, Ya-Wen CHEN, Ming-Nan LIN (TWN)

The longitudinal study for the associated factors to job performance among nurses in emergency department

Kuan-Chen CHEN, Tao-Hsin TUNG, Shy-Yang CHIOU, Fu-Li CHEN (CHN)

Mental performances in anaesthesia residents after night work: analysis of visual and auditory reflexes with new mobile APP "SafeDrive"

Rym BEDNAROVA, Luca MICELI (ITA)

Health promotion effects of exercise intervention in nurses

Shu-Mei LIN, Ting-Yao WANG, An-Ko YANG, Jui-Mei TSENG, Wan-Zhen LIN, Hui-Ting HUANG, Kuan-Hung LIN (TWN)

Measures to promote the well-being of healthcare professionals at work

Concetta MAZZA, Cinzia DE ANGELIS, Daniela DI FABBIO, A. Maria GRASSILLI, Daniele TOVOLI (ITA)

Determining the impact of a corporate wellness program upon cardiac health for a group of employees

Peter CHUK, Albert TSAI, Alan SIU (HKG)

PROGRAM DETAILS

FRIDAY, June 8, 2018

O4.6 Community health promotion II

Venue: Sala Maggiore, Bianca Room

Chair: Luciana BALLINI (ITA)

How people living in Hiroshima value each prerequisite for health from the Ottawa Charter

Toh Yoon Ezekiel WONG, Takako SUGA, Narumi MURAKAMI, Junko TATEISHI, Hirohiko MURATA (JPN)

The more times people participate in a CVD community intervention program, the greater the decrease in mortality

Margareta NORBERG, Mojgan PADYAB, Lars WEINEHALL (SWE)

Educating Health Guides to improve individual empowerment in a small community

Alexandra WHITE, Anna-Karin SCHÖLD, Elin GLAD, Matti LEIJON (SWE)

A.F.A. Adapted Physical Activity

Alda COSOLA, Rodolfo ODONI, Pasquale ROSIELLO, Sabina BORRACCINO, Rossella SAPPÈ, Paola FASANO, Flavio BORASO (ITA)

“Catch your health wave on the beaches of Ashdod” – An outdoor intervention to promote sun protection among beachgoers

Karen BRONNER (ISR)

O4.7 Late life and health promotion

Venue: Sala Maggiore, Rossa Room

Chair: Giulio FORMOSO (ITA)

The effectiveness of exercise program intervention in fitness and social interaction for elderly patients with dementia.

Ying-Ya HSU, Jia-Fu LEE, Yueh-Chuan YANG, Ya-Jou YU (TWN)

THE “NORTH COAST HERO” MEDICAL CARE ALLIANCE An Innovative Mode of Cross-sectoral Continuous Long-term Medical Care and Health Promotion

Ching-Ting TAN, Yu-Chien HUNG, Hsiang-Lien HUNG, Jia-Jhen JHANG, Hsu-Hua LIU (TWN)

Setting-based Health Promotion in Long-term Care Institutions

Shu-Chen SU, Sou-Hsin CHIEN, Ching-Yuan CHEN, Cai-Ru GAN, Yi-Ling LAI (TWN)

CONTINUOUS CARE MODEL OF GRIEF COMPANIONSHIP - Change of Family Members of the Deceased from Passive Acceptance of Care to Active Dedication of Themselves

Hsu-Hua LIU, Jia-Jhen JHANG, Hsiang-Lien HUNG, Yu-Chien HUNG, Ching-Ting TAN (TWN)

O4.8 Migrants and vulnerable groups

Venue: Sala Maggiore, Ciano Room

Chair: Elizabeth ABRAHAM (CAN)

Ensuring access to health care for refugees and asylum seekers during the refugee crisis: development of a resource package for EU member states

Antonio CHIARENZA, Hans VERREPT, Marie DAUVIRIN, Sonia BAATOUT, Valentina CHIESA (ITA)

PROGRAM DETAILS

FRIDAY, June 8, 2018

Training programmes for health professionals that address access and quality of health care delivery for migrants and ethnic minorities in Europe: a review of existing training materials

Antonio CHIARENZA, Lidia HORVAT, Katja LANTING, Anna CIANNAMEO, Jeanine SUURMOND (ITA)

Reception of “unaccompanied” minors: their and our future in Reggio Emilia

Michela CAPORUSSO, Rossano FORNACIARI, Francesca BONVICINI, Carmen CASONI, MariaCristina GEMMI, Mara MANGHI, Alberto MANTOVANI, Teresa FONTANESI, Emanuela NASI (ITA)

Maintaining Equality and Rights in Medical Care: A Case Study of Patients without Household Registration in Taipei Tzu Chi Hospital

Chia Te LIN, Fang Chien WU (TWN)

Evaluation of remote intercultural mediation / interpreting using video-conference technology in Belgian health care

Hans VERREPT (BEL)

From the cattle-shed to the rooms of health: programs for the wellbeing of workers and animals

Carla SEVERI, Alessandra FABBRI, Francesca BONVICINI, Loredana GUIDI, Lucia MONICI, Stefania MOZZANICA, Carmen CASONI, Antonio POETA, Araceli BARRUS (ITA)

O4.9 WORKSHOP: Using the Transtheoretical Model of Change to address life-style risk factors: an interactive workshop of the Emilia-Romagna center for prevention and health promotion

Venue: Sala Maggiore, Magenta Room B

Chair: Marco TAMELLI (ITA)

Sandra BOSI, Cristiano CHIAMULERA, Fabrizio FAGGIANO, Giuseppe GORINI, Marco TAMELLI, Carlo Di CLEMENTE, Ermanno RONDINI (ITA)

O4.10 WORKSHOP: Towards a consensus on a revised version of the green book

Venue: Sala Maggiore, Rossa Room B

Chairs: Margareta KRISTENSON (SWE), Hanne TØNNESEN (DNK)

Martin Kraye von Krauss (WHO/Euro)

PROGRAM DETAILS

FRIDAY, June 8, 2018

13:30-14:15 Mini oral sessions 2

M2.1 Using ICTs to promote health

Venue: Sala Maggiore, Celeste Room

Chair: Alan SIU (HKG)

Efficacy of Cloud Health Stations - Association between Services Received Frequency and Blood Pressure Control

Ta-Chuan HUNG, Chih-Hung HSU, Tsu-Hsueh HUANG (TWN)

Enhance the Effectiveness of Bedside Blood Sugar Detection

Li-Ming CHUANG, Truey-Yeh SONG (TWN)

Applying Telehealth to High-technology Workers to Improve Glycemic Control

Yu-Wen YANG, Ju-Hsien WU, Yu-Chin HUANG, Ying-Hsun WU (TWN)

Quantifying the relationship between diseases and symptoms using big data

Lee-Ching HWANG, Hsin-Hui SHAO, Shih-Han LIN (TWN)

M2.2 Promoting physical activity of patients and community

Venue: Palazzo della cultura e dei congressi, Italia Room

Chair: Thor Bern JENSEN (DNK)

Physical fitness performance in adults aged 23 to 64 years in Taiwan

Cheng-Wei WANG, Ching-Fang TSAI, Jian-Yu WANG, Pei-Ling WU, Shan-Ching HUNG, Jung-Ying HOU, Wei CHEN (TWN)

Association with physical activity and health promotion behaviors among university students in South Korea: Focusing on the freshman health survey in an university

Young Bok KIM (KOR)

Using APP to establish supportive network to increase urban elders exercise intensity

Yun-Yu HUANG, Xiong-Fei JIAN, Ying-Hua XIE, Shi-Xin ZHANG, Zhong-Ying LU, Sheng-Feng TSAI, Hsin-Jou HO, Yin-Huan WU, Hsiu-Chun FANG (TWN)

M2.3 Tobacco cessation

Venue: Palazzo della cultura e dei congressi, Bologna Room

Chair: Rudi GASSER (AUS)

Making The Healthy Choice The Easy Choice

Trevor PHILLIPS (IRL)

Promote Smoke-Free Family in Cambodia - An Experience of Taiwan's smoke-free hospital

Shan-Sian YU, Kuang-Chieh HSUEH, Hong-Jhe CHEN, Yun-Ju SHEN, Fan-Yun SHEN, Chia-Hua LEE, Chieh-Chun HUAI, Lee-Fei PAN, Jin-Shiung CHENG (TWN)

Implementation of Tobacco Cessation Program for Workplaces and Pregnant Women in Taiwan

Chih-Hsien CHEN, Chi-Hua YEN, Kai-Lun SHEU (TWN)

PROGRAM DETAILS

FRIDAY, June 8, 2018

Efficacy of a smoking cessation intervention based on transtheoretical model

Fang Chun WEI, Chii JENG (TWN)

M2.4 Salutogenic hospitals

Venue: Sala Maggiore, Indaco Room

Chair: Chin-Lon LIN (TWN, tbc)

Do nurses working in health promoting hospitals have better health behaviors?

Wen-Yen LO, Li-Yin CHIEN, Shu-Ti CHIOU, Nicole HUANG (TWN)

Health Purchasing Practices In The Workplace Health Promotion – A Case Study of A Medical Center In Southern Taiwan

Wei-Ling HUANG, Ling-Sui CHEN, Ying-Chen CHEN, Tzu-Yun LIN, Xiao-Jie HUANG, Chao-Ling WANG (TWN)

New perspective of hospital management under third party accreditation: patient-centered cultural construction- a case study of the improvement on emergency care process in an academic medical center in Southern Taiwan

Chia-Fang CHANG, Yi-Hsuan CHANG, Ling-Sui CHEN, Chi-Tung PENG, Fang-Li KUO, Yen-Yi LEE, Yao-Hua LIU (TWN)

Improvement of sleep and mood in hospital-based nursing home residents using innovative light facility change

Sheng-Hsing LAN, Yi-Chien YAO, Che-Chang HU, Lan LAN, Chiu-Ming KUO, Ying-Chun LI (TWN)

Indoor Air Quality in inpatient wards: a monitoring activity for design and management strategies in healthcare facilities

Marco GOLA, Gaetano SETTIMO, Stefano CAPOLOGO (ITA)

Preparedness for Dementia's Caregiving Roles: A case study of Coordinated and Multi-Specialization Collaborative platform

Ching-Yuan CHEN, Cai-Ru GAN, Sou-Hsin CHIEN, Yi-Ling LAI, Pin-I CHANG, Lin-Ying HSU (TWN)

M2.5 Monitoring and implementation of health promotion strategies and standards

Venue: Sala Maggiore, Rossa Room A

Chairs: Rie RAFFING (SWE)

Developing a working group to implement HPH Standards

Manel SANTIÑÁ, Dolors JUVINYÀ, Anna Carol PÉREZ, Rosa SIMON, Veronica ROMERO, Helena MESTRE, Silvia CARBONELL, Gemma NAVARRO, Cristina INIESTA (ESP)

Development and validation of healthy hospital recognition in Taiwan: a pilot study

Hsi-Lung HUNG, Chen-I SHIH, Hui-Fei YANG, Huei-Yu LEE, Wei CHEN, Yueh-Han HSU (TWN)

Age-friendly Recognition version 2 for Primary Health Care Centers: A Pilot Study

Hui-Fei YANG, Pei Hsuan LEE, Hsi-Lung HUNG, Kuan-Ya HUANG, Tzu-Jung LI, Ya-Han SU, Wei CHEN (TWN)

PROGRAM DETAILS

FRIDAY, June 8, 2018

ANTIMICROBIAL STEWARDSHIP: Infections control in nursing homes, Reggio Emilia
Alessandra FERRETTI, Ermanno GABBI, Pietro RAGNI, Daniela ZOBOLI, Anna LIOTTI,
Sonia ROMANI, Corrado BUSANI, Cristina MARCHESI, Marietta LORENZANI,
Carlo CAPATTI, Silvia SORCHI INCERTI, Valentina CHIESA (ITA)

M2.6 Community health promotion

Venue: Palazzo della cultura e dei congressi, Bianca Room
Chair: Kaja PÖLLUSTE (EST)

Discussion about the application of hybrid courses model in community health promotion activities

Shu-Chen LEE, Wei-Hsin HUANG, Li-Jen LIANG, Yu-Hua CHEN, Jui-Yun CHUANG,
Chia-Mei CHANG, Chiu-Chen CHEN, Yu-Shan LEE (TWN)

ProWeB Model: Promoting well-being. The School as a social network for Health Promoting

Lamia CHANNOUFI (ITA)

Promoting Shared Decision-Making for Colorectal Cancer Screening

Tsung Lung TSAI, Chun Yi WU, Yi Hua CHIANG, Po Wen SU, Kuan Chih LEE,
Ying Ju FANG, Kang Ming PENG (TWN)

Promotion of appropriateness in antibiotic use: campaigning citizens to influence doctors?
Giulio FORMOSO (ITA)

The Policy Affects the Acceptance of Influenza Vaccination in Different Aged People in a Regional Hospital in Taipei

Yun-Chen KO, Chin-Yu HO, Wen-Ruey YU, Yi-Ju CHEN ()

M2.7 Disease management

Venue: Sala Maggiore, Magenta B Room
Chair: Astrid LOIDOLT (AUT)

Hyperglycemia and Cancer Risks-Using a Population-Based Adult Preventive Care Service Data in Taiwan

Ying-Wei WANG, Ran-Chou CHEN, Shu-Li CHIA, Yi-Ping LIN, Shao-Wen CHIU (TWN)

Effect of dietary intervention to prevent recurrence of urolithiasis

Youkyoung LEE, Hwanchul SON, Hyun JEONG, Minchul JO, Sungyong JO, Juhyun PARK,
Sangjun YOU (KOR)

Vegetarian diets are associated with less obesity, and metabolic risk factor among Taiwanese adult: a hospital- based study in Northern Taiwan

Ching-Fen HSU , Hao-Wen LIU (TWN)

Web- based education for people with COPD

Margaretha LUNDIN, Clara HELENIUS, Madelene LUNDELL, Gun-Britt LINDQVIST (SWE)

PROGRAM DETAILS

FRIDAY, June 8, 2018

M2.8 Mental health and health promotion in psychiatric care

Venue: Sala Maggiore, Ciano Room

Chair: NN

Early intervention in psychosis in the Reggio Emilia Mental Health Department: findings from a 3-year follow-up study

Lorenzo PELIZZA, Silvia AZZALI, Federica PATERLINI, Ilaria SCAZZA, Sara GARLASSI, Veronica BARBANTI SILVA, Francesca FONTANA, Rosanna FAVAZZO, Michela FABIANI, Luana PENSIERI, Michele POLETTI, Luigi Rocco CHIRI, Leonardo CIONCOLINI, Andrea RABALLO, Enrico SEMROV (ITA)

Clinical Health Promotion: Preventing Violence with Healthy Lifestyle Modification Interventional Program in Psychiatric Patients

Mei-Chi HSU (TWN)

Facilitating happiness and preventing suicide by a longitudinal community-based project in New Taipei City

Chun-Kai FANG, Hsueh-Wen HSIAO (TWN)

The most immediate and intimate service. A rehabilitation model of people with mental illness in a medical center in southern Taiwan

Chia-Fang CHANG, Po-Tse WU (TWN)

The Impact of Work Rehabilitation on Individuals with Chronic Mental Illness — Take Janitor Training as an Example

Kai-Han LIN, Shau-Ping SHIU (TWN)

M2.9 Maternal and child health promotion

Venue: Sala Maggiore, Rossa Room

Chair: Elvira MENDEZ (ESP)

A Comparison of Factors Associated with Cessation of Exclusive Breastfeeding at 1 and 2 Months in Taiwan

Pei-Chi CHANG, Sin-Fong LI, Hsin-Yi YANG, Li-Chu WANG, Cing-Ya WANG, Kuan-Fen CHEN, Wei CHEN, Shan-Ching HUNG (TWN)

The Association between Early Breastfeeding and Postpartum Depression in Taiwan

Hsiao-Chen CHIU, Jun-Chin HSIAO, I-Shiang TZENG (CHN)

An integrated project of child health surveillance through current information flows. The LINFA project

Riccardo PERTILE, Lucia BOMBARDA, Silvano PIFFER (ITA)

The effect of promoting child development in pre-school children in Taiwan

Sen-Wei TSAI (TWN)

M2.10 Patient empowerment and community involvement

Venue: Sala Maggiore, Rossa Room B

Chair: NN

PROGRAM DETAILS

FRIDAY, June 8, 2018

The hospital and the community built a float-ball garden of health promotion and ecological art

Hsiang-Lien HUNG, Hsu-Hua LIU, Hsiao-Yu CHANG, Ching-Ting TAN (TWN)

The Efficacy of Using Animation to Promote the Memory Maintenance Club to the Public in Rural Communities

Ping-Nan WU, Sin-Mei WU, Yi-Ting LU, Chia-Min LAI, Hung-Mei CHEN, Chiu-Man LIU, Wen-Long TSAO, Ming-Nan LIN (TWN)

If a doctor ask, the patient changes

Juhee AHN, Yujin CHUNG, Sujoung LEE (KOR)

Sharing decision making about PSA test for prostate cancer early detection

Pietro RAGNI, Paolo Giorgi ROSSI, Mirco PINOTTI, Federica GAZZOTTI, Valentina BEDOGNI, Rossana COLLA, Valentina CHIESA, Giorgio MAZZI, Cristina MARCHESI (ITA)

Empathy – an important concept in measures to promote health

Jan ARLEBRINK (SWE)

PROGRAM DETAILS

FRIDAY, June 8, 2018

15:30-16:15 Poster sessions 2

P2.1 Chronic disease management II

Venue: Sala Maggiore, second floor

- P 230. Screening of Late-Onset Pompe Disease in a Sample of Taiwan Chang Bin area Patients With Liver Function Etiology**
Shing Sung CHIA, Pei-Jhu SHIH, Cang-An LYU, Kai-Han Lin (TWN)
- P 231. Diabetic friendly care for disabled - The clinical experience of Diabetes Home Visit Service**
Li-Hsin CHIEN, Chao-Tsen KUO, Hsueh-Mei LO, Hsiao-Ling CHUANG, Jiun-Sheng HSIEH, Su-Huey LO (TWN)
- P 232. Impact of self-measurement frequency via mobile health application on blood glucose and blood pressure levels**
Hee Dong PARK, Jae Ho OH, Seung Hee HAN, Ga Yang SHIM, Doyen KIM (KOR)
- P 233. Improving Implementation Rate of Ophthalmoscopy in Regional Hospital**
Chia-Jung TSAI, Chiu-Hsia YU, Ming-Jen HUANG, Shu-Yi WEI, Ming-Fen CHENG (TWN)
- P 234. GDM Intimate Care Program --- The Clinical Experience from a Regional Teaching Hospital**
Hsueh-Mei LO, Jui-Hsiang LI, Show-Wen CHEN, Su-Huey LO (TWN)
- P 235. The effectiveness of a professional support program on medication adherence of patients with glaucoma in southern Taiwan**
Yuh-Wei WANG, Kuo-Chi HUNG, Hua-Kuei LEE (TWN)
- P 236. The Effectiveness of Integrated Chronic Kidney Disease Early Stage Care Program.**
Tsung-Lung TSAI, Miao-Ju FANG, Po-Wen SU, Hui-Yun CHEN, Kai-Ling CHANG, Su-Chao LIN, Yu-Ling HSIAO, Hwey-Fang LIANG (TWN)
- P 237. Care Needs and the associated factors of Primary Caregivers of Liver Cirrhosis Patients**
Truey-Yeh SONG (TWN)
- P 238. The efficacy and economic benefit of diabetes share care program in a regional teaching hospital**
Chao-Then KUO, Su-Huey LO (TWN)
- P 239. Investigation of Associated Factors and Resource Utilization of Delayed Hemodialysis in End-Stage Renal Disease Patients**
Hsiu-Chin MAI, Hon-Yi SHI, Szu-Chia CHEN, Yi-Han CHANG (TWN)
- P 240. The Association between Health Promoting Lifestyle and self-care, self-efficacy among Hemodialysis and Peritoneal Dialysis Patients in Taiwan**
Ling-Shou CHEN, Te-Feng YEH, Cheng-Hsu CHEN, Yu-Chia CHANG, Li-Ling HUANG, Chuan-Hsiung LIN, Chien-Tsai HUANG (TWN)

PROGRAM DETAILS

FRIDAY, June 8, 2018

- P 241. Protected discharge of the patient with diabetes who begins insulin therapy in hospital and hospital-territory continuity**
Valeria MANICARDI, Massimo MICHELINI, Aldo Ugo PAGLIANI, Elisa MANICARDI, Marco GANASSI, Enrica MANICARDI, Sonia ROMANI, Marina GRECI, Marina IEMMI (ITA)
- P 242. Using SDM to improve the insulin injection rate of diabetes patients**
Wen-Yu WANG, Yu-Chen FAN-CHIANG, Yu-Ping HO, Shu-Ting CHUANG, Sou-Hsin CHIEN (TWN)
- P 243. Diabetic Hemodialysis Patients Foot Health Care Promotion**
Yu-Hsueh HOU, Yu-Hung WANG, Wen-Jan YAU, Yu-Wen LIN, Nan-Ping YANG, Ching-Feng LIN (TWN)
- P 244. Hepatitis A outbreak in region of Lazio (Italy) mostly affecting men who have sex with men**
Maria Rosaria NAPPI, Antonella DE MARCHIS, Anna BISTI, Alessio PENDENZA, Claudio LAZZARI, Maria Alessandra BRANDIMARTE, Enrico DI ROSA (ITA)
- P 245. Effect of sugar-free coffee intake on the control of diabetes mellitus: a cross-sectional study in an urban hospital**
Hsun-Pai WU, Shih-Chueh CHEN, Kuo-Ting SUN (TWN)
- P 246. Bidirectional association between psoriasis and multiple sclerosis: a systematic review and meta-analysis of observational studies**
Chia-Yu LIU, Tao-Hsin TUNG, Chin-Yu LEE, Shu-Hui WANG, Ching-Chi CHI (TWN)
- P 247. Effect of green tea intake on the control of diabetes mellitus: a cross-sectional study in an urban hospital**
Shih-Chueh CHEN, Hsun-Pai WU, Kuo-Ting SUN (TWN)
- P2.2 Community health promotion and public health**
Venue: Sala Maggiore, second floor
- P 248. Health promotion programs based on Taoyuan area are involved in the health outcomes of elders in a school**
Yi-Lien LIU, Pei Chen YANG, Hui Wen HSU, Chien Kai MAI (TWN)
- P 249. The Risk of liver disease in Homecare nurses : A 14-Year Nationwide Population-Based Cohort Study**
Yuan-Tsung TSENG, Heng-Horng WANG (TWN)
- P 250. The Occupation Stression and Risk in Homecare nurses: A 14-Year Nationwide Population-Based Cohort Study**
Yuan-Tsung TSENG, Heng-Horng WANG (TWN)
- P 251. Effect of health education intervention on oral health improvement for home care patients**
Yu-Hsuan TANG, Meng-Szu LEE (TWN)
- P 252. An Epidemiological Analysis of Head Injury 10 Years after Helmet Policy in Taiwan**
I-Lin HSU, Li-Chien CHIEN (TWN)

PROGRAM DETAILS

FRIDAY, June 8, 2018

- P 253. Role of the hospital in public health promotion**
Tomas PETR, Lenka GUTOVA (CZE)
- P 254. Cross-team social safety network in Shilin District - Community-based home guardianship**
Wen-Yu LEE, Jo-Fen YEH, Sheue-Shya LIOU, Lu-Fang YUAN (TWN)
- P 255. Health Check-up Support for Newlywed and Soon-to-be Married Couples; How to Improve the Health Awareness and Encourage Childbirth of Young Adults in Family Formation**
Jaekyung LEE, Bumjo OH, Yong Jin JUNG, Ji Won KIM, Byeong Gwan KIM, Sookyung KIM (KOR)
- P 256. The use of SNS (Social Network Services) in weight-loss program can increase weight-loss effectively**
Jiyuen-Tieng CHEN, Hui-Chun LIN, Hsiao-Jung TSAI, Su-Ji LIN, Hui-Ting HUANG, Shu-Mei LIN (TWN)
- P 257. A matrix approach strategy by health promoting hospital to improve awareness of stroke in the community.**
Heui Sug JO, Su Mi JUNG, Saerom KIM (TWN)
- P 258. Managing hospitalization period of inpatients for public health promotion in regional community**
Ji-Ung PARK, Sunjoo KIM, Juhyun KU, Hanna KIM, Dongwon SEOL, Min-Hyun PARK (KOR)
- P 259. Community health assessments targeting residents over the age of 40 in Zhenxing Village, Cijin Island, Taiwan (R.O.C.)**
Yu-Syuan YEN, Hsiuen CHEN, Mei-Han LIN, Min-An LIEN, Ming-Wen WANG, Woan-Yun KO, Yi-Chin HO, You-Ren CHEN, Shu-Yuan JIAN (TWN)
- P 260. The relationship between abstinence confidence and dependence behavior in betel quid chewing in Taiwan**
Pei-Chi Chang, Chen-Yuan Hsu, Shu-Pi Chiu, Yi-Ching Huang, Ya-Yen Huang, Wei Chen (TWN)
- P 261. The Effectiveness of “Family Doctor Integrated Delivery System” in a Country Area of Central Taiwan**
I-Ching LIN, Pei-Yu YANG, Ying-Li LIN, Pei-Ju HUANG (TWN)
- P 262. HIV: How to Identify Vulnerability: Permanent project to prevent sexually transmitted diseases and health promotion**
Rossano FORNACIARI, Carmen CASONI, Francesca BONVICINI, MariaCristina GEMMI, Rosamaria DURZO, Sara GUATELLI, Nicola CEINAR, Elisabetta PASTORE, Rajni BAGGA (ITA)
- P 263. Healthy City in Korea: The Way it Works**
Eunjeong KANG (KOR)
- P 264. Intercultural mediation for the care of women who have been victims of sexual violence and/or have been abused during pregnancy**
Giulio FORNERO, Mario CASERTA, Paola CASTAGNA, Antonella CANAVESE, Grace RABACCHI, Imelda TESINI (ITA)

PROGRAM DETAILS

FRIDAY, June 8, 2018

- P 265. Tobacco informers key persons, when introducing non-smoking outdoor environments in hospitals**
Anna-Karin SCHÖLD, Elin GLAD, Alexandra WHITE, Matti LEIJON (SWE)
- P 266. Using Group Activity to Improve the Physical and Psychological Health of Residents-Experience of a Regional Public Hospital**
En-Tien YEH, Yi-Ping LIN, Sheng-Hua TSAI, Yu-Wen LIN, Nan-Ping YANG, Ching-Feng LIN (TWN)
- P 267. Relationship of impression management and organizational citizenship behavior with job performance: the case of physical therapists**
Wan-Yun HUANG, Yu-Lung WU, Min-Hui LI, Fu-I HOU, Jin-Shiung CHENG (TWN)
- P 268. The experience of multiple nutrition education methods for chronic disease prevention in local community**
Shu-Chen KO, Mei-Ying CHEN (TWN)
- P 269. The Relationship between health risk behavior patterns and health-related quality of life among citizens in 25 regions of Seoul metropolitan area**
Hyeyun KIM, Hyekyeong KIM (KOR)
- P 270. Behavioral and environmental approaches to build healthy campus in South Korea: A case of the harmful drinking prevention project**
Young Bok KIM (KOR)
- P2.3 Community health promotion for the elderly**
Venue: Sala Maggiore, second floor
- P 271. Self-rated health and its relationship to health behavior for the elderly by using the Happiness & Health Feeling Scale (2 HFS)**
Kazuyo FURUKAWA, Kaori TERAOKA, Minako SUZUKI, Fumie ONO, Tamiki HIRASAWA, Kyoto NEGISHI, Norio SHIMANOUCHI (JPN)
- P 272. A Practice of Health Care at Day-Care Centers in Community: Caring for the Disadvantages and the Elders at Health Hospital in Taiwan**
Hsiu-Chu CHIANG, Tzu-Hui HUANG, Hsiu-Shan WU, Kuo-Hsing LIN, Tien-Sheng TSAI, Ming-Feng HOU, Shui-Fu HSIEH (TWN)
- P 273. How to promote community middle-aged health program- Example of southern Taiwan regional level public hospital**
Chi-Cheng HUANG, Chun-Huang LAI, Feng- Qing SUN, Shu-Nu CHEN, Xue-Zhen LAI, Ri-Gu YE (TWN)
- P 274. Oral Movement Exercise and Lower Limb Exercise for Seniors**
Ting-Feng YANG, Ya-Chu YU, Hung-Yuan LIU (TWN)
- P 275. Community-Focused Space:Community Senior Center in Taiwan**
Hsiangyi CHEN, Shu-Chen LEE, Chao-Chi WANG, Yu-Shin CHANG (TWN)
- P 276. The Effects of Health Promotion Activities on Body and Mind in the aging population**
Pei-Ching LIN, Ren-Huai CHANG, Ya-Ai CHENG, Hsiu-O HUANG (TWN)

PROGRAM DETAILS

FRIDAY, June 8, 2018

- P 277. The effect of group music therapy for older people with dementia**
Yu-Hsuan TANG (TWN)
- P 278. Initial Exploration into the Quality and Effectiveness of Discharge Planning Case Manager**
Pi-Hsueh CHEN, Chun-Ling LIN, Ming-Wen TSAI, Yi-Ju HUANG, La-Ling CHEN, Hsiu-Chu CHIANG, Chun-Hung CHEN (TWN)
- P 279. The Efficacy of Auricular Acupressure on Improving Sleep Quality in Elderly**
Yi-Chin LEE, Yi-Heng LIU (TWN)
- P 280. A Study of the Application to Health Promotion of the Elderly: by Research the Evidence-Based on Taitung Aboriginal Community**
Hsien-Yi LO, Hui-Lin CHOU, Jen-Lain SHYU, Mei-Ling CHEN (TWN)
- P 281. Construct A Dine-together Model in community-living elderly, Taiwan Experience**
Mei-Yuan LIU, Cheau-Jane PENG (TWN)
- P 282. Community-based prevention and delaying disabled elderly services**
Pei Chen YANG, Yi-Lien LIU, Li Fen CHOU, Li Shen CHIH (TWN)
- P 283. Efficacy of Application of Exercise Promotion Model for the Healthy and Prefrail Community Dwelling Elderly in Taiwan**
Meng-Yueh CHIEN, Jau-Yih TSAOU, Hsuei-Chen LEE, Pay-Shin LIN, Yi-Ju TSAI, Pei-Yun LEE, Ching-Yi WANG, Li-Ju LIN, Li-Hui YU, Ying-Wei WANG (TWN)
- P 284. The Effects of Self-Management Program on the Degenerative Osteoarthritis in a Community Elderly.**
Eunhee CHOI, Kiheon LEE, Sukwon PARK (KOR)
- P 285. Community-based health promotion program on the prevention of sarcopenia in elderly population**
Tzu Yang HAN, Hsin Chun CHEN, Tong Yun HSIAO, Chun Han TSENG, Hung Yu HSIEH, Yu Shan HUNG, Chung Feng WENG (TWN)
- P 286. The experience of Taiwan in Prevent declining physical function of elderly in Community**
Ya Hui CHOU (TWN)
- P 287. Evaluation of the Effects of Cognitive -based Training Programs for Community-dwelling Older People in Taiwan**
Wenyi-Yi HUANG, Po-Yen CHEN, Huei-Lan LU (TWN)
- P2.4 Health literacy and communication**
Venue: Sala Maggiore, second floor
- P 288. People Health Literacy Skills and Physician-Patient Communication at Mennonite Christian Hospital in Hualian City, Taiwan**
Wan-Hsin CHEN, Yea-Pyng LIN, Chien-Ju CHEN, Chih-Yao LIN (TWN)

PROGRAM DETAILS

FRIDAY, June 8, 2018

- P 289. Applying the shared decision making (SDM) model to provide a choice for patients of production**
Ya-Hsiu CHANG, Ren-Shi SHYU, Xue-Yu CAI, Xing-Wen YIN, Jing-Ru PAN, Rui-Lian WANG, Yi-Lien LIU (TWN)
- P 290. An Outcome Evaluation of the Community Pharmacy Efforts to Improve Health Literacy**
Noritake HIROTA, Mayumi INAGAKI, Naomi MATSUMURA, Yuya HOJYO, Manami KAMIURA, Minako OGASA, Reiko UTSUNOMIYA (JPN)
- P 291. Improving Health literacy in Community populations with hypercholesterolemia**
LI-Ju HUNG, Hsiang-Ju PAN, Ru-Yih CHEN, Jin-Shiung CHENG (TWN)
- P 292. Alliance for Health Literacy in the Czech Republic (AHL)**
Milena KALVACHOVÁ, Alena ŠTEFLOVÁ (CZE)
- P 293. The analysis of effectiveness to promote the evaluation of adverse effect after chemotherapy by information system**
Ya-Ting WANG, Chi-Ying I, Hui-Chuan HUANG, Li-Chun HUNG, Yi-Ju HUANG, Ya-Ling CHEN, Shu-Hui CHUANG, CHEN Huang-Chi (TWN)
- P 294. Using evidence-based shared decision-making to help patients with end-stage renal disease**
Ling-Chih CHI, Hsuan-Kuang CHUNG, Yin-Jing LIAO, Ting-Tzu WU, Yi-Fan TSAI (TWN)
- P 295. Improve of effective communication between health care workers and patients' families by using the mnemonic phrases and media teaching**
Jie-Shin KUO, Wen-Hsuan SU, Yan-Jin YANG, Sung-Yun CHEN, Yi-Fan TSAI (TWN)
- P 296. Taiwan Government's Achievements in Promoting "Guidelines for the Use of Health Literacy and Friendly Material Review"**
Chia-Hui LEE, Chiao-Ching LIU, Hsiao-Huey LU, Shu-Ying LO (TWN)
- P 297. Effectiveness of online training course on health literacy for healthcare professionals in Taiwan**
Mei Chuan CHANG, Ying Wei WANG, Mi Hsiu WEI, Jyh Gang HSIEH (TWN)
- P 298. Evaluation of street champaign for awareness of Acute Myocardial Infection symptoms and coping method**
Jiyoung MOON, HeyJean LEE, Danbi CHOI, Yeonheui BAEG, Youngmi KIM (KOR)
- P 299. From Professional Sharing to Patient Empowering: Using Interdisciplinary Collaboration in Hemodialysis Medical Education Film-Making as an Example**
Edwin LEE, Li-Cheng CHANG, Dai-Ni LI, Paul HUANG (TWN)
- P 300. Development and Application Assessment of Health Literacy Instrument among Chronic Kidney Disease patients.**
Chiong-Hsuan CHIU, Jue-Zong YEH, Ian CHEN, Yu-Juei HSU, Chung-Jen WEI, Jia-hui SHIH, Ying-Wei WANG (TWN)
- P 301. Analysis of Patient Understanding of Drug Label Information**
Ju-Fang WU, Chen-Ying SU, Po-Chuen SHIEH, Wen-De LA (TWN)

PROGRAM DETAILS

FRIDAY, June 8, 2018

- P 302. Project for Enhancing the Completeness of Nursing Instructions for Children Newly Diagnosed with Cancer**
Hsiu-Mei LIU (TWN)
- P 303. The level of health literacy in parents of 0-4 year-old children**
Cristina PERRUCA MARTINEZ, Rosa SUÑER-SOLER, Wifred RICART ENGEL, Dolors JUVINYÀ CANAL (ESP)
- P 304. The characteristics of health care settings can affect the satisfaction of health literate friendly environment in different patients**
Jyh-Gang HSIEH, Mi-Hsiu WEI, Mei-Chuan CHANG, Ying-Wei WANG (TWN)
- P2.5 Health promotion in psychiatric care**
Venue: Sala Maggiore, second floor
- P 305. Expectations of internal and external customers for a public psychiatric hospital in Korea**
Sang Jun EUN, Hyun Joo KIM, Jin Yong LEE, Hee-Sook KIM (KOR)
- P 306. The “Reggio Emilia At-Risk Mental States” (ReARMS) project: 2-year follow-up findings on individual cognitive-behavioral therapy in young people at Ultra-High Risk for psychosis.**
Lorenzo PELIZZA, Silvia AZZALI, Federica PATERLINI, Ilaria SCAZZA, Sara GARLASSI, Veronica BARBANTI SILVA, Francesca FONTANA, Rosanna FAVAZZO, Michela FABIANI, Luana PENSIERI, Michele POLETTI, Luigi Rocco CHIRI, Andrea RABALLO, Enrico SEMROV (ITA)
- P 307. The approved Italian version of the comprehensive assessment of at-risk mental states (CAARMS-ITA): field-test and psychometric features.**
Lorenzo PELIZZA, Andrea RABALLO, Enrico SEMROV, Federica PATERLINI, Silvia AZZALI, Luigi Rocco CHIRI, Ilaria SCAZZA, Sara GARLASSI, Francesca FONTANA, Rosanna FAVAZZO, Veronica BARBANTI SILVA, Michela FABIANI, Luana PENSIERI, Michele POLETTI, Leonardo CIONCOLINI (ITA)
- P 308. Schizophrenia Patients at Higher Risk of Hyperlipidemia and Dyslipidemia and Association of Statin Use and Subsequent Mortality: A 12-year Nationwide Population Based Study**
Li-Hsiang WEI, Mei-Chi HSU, Chia-Yi TUNG (TWN)
- P 309. Clinical Evaluation of Cholesterol and High-density Lipoprotein as Indicator for Violence Risk and health Promotion Strategy in Patients with Mental Illnesses**
Mei-Chi HSU (TWN)
- P 310. Reduce the incidence and severity of falls in chronic psychiatric ward**
Mei-Wen KUO, Yi-Huang WANG, Kai-Han LIN (TWN)
- P 311. An Investigation into the Effects of TRM on the Treatment Plan in a Rehabilitation Psychiatric Ward**
Pei-Shan LI, Huei-Lan LU, Ching-Ming CHENG (TWN)

PROGRAM DETAILS

FRIDAY, June 8, 2018

- P 312. The Effectiveness of Health Management to Community Low-income Households and Vulnerable Psychiatric Patients in Psychiatric Center Southern of Taiwan**
Yi-Chen HSIEH, Huei-Lan LU (TWN)
- P 313. Study on the Related Factors of Falls in Psychiatric Inpatients**
Huizhen CHEN, Xuqiao ZHANG, Suzu CHENG, Weixin WU, Tingzhong HUANG, Yu-Wen LIN, Nan-Ping YANG, Ching-Feng LIN (TWN)
- P 314. Exploring the Effectiveness of Applying Motivational Interviewing on Quitting Smoking in Psychiatric Patients**
Yu-Chun TASI, Hsueh-Yin WANG, Huei-Lan LU (TWN)
- P 315. Promoting Nursing Information Project to Enhance the Integrity of Psychiatric Ward Nursing Record Forms**
Huizhen CHEN, Anan CHEN, Suzu CHENG, Wenzhen YAO, Tingzhong HUANG, Yu-Wen LIN, Nan-Ping YANG, Ching-Feng LIN (TWN)
- P 316. The Effectiveness of Applying the Maslow's Needs Theory to Establish a Self-learning Model in a Psychiatric Rehabilitation Ward**
Yu-Kuei TSENG, Huei-Lan LU (TWN)
- P 317. The Effects of Drug Refusal and Violent Situation Simulation Training in Psychiatric Wards**
Huizhen Chen, Suzu Cheng, Shumei Zhong, Wenzhen Yao, Weixin Wu, Tingzhong Huang, Yu-Wen LIN, Nan-Ping YANG, Ching-Feng LIN (TWN)
- P 318. Supportive employment services for mental disabilities to enhance healthy lifestyle**
Chun-Kai Fang (TWN)
- P 319. Persistently developing the sheltered workshop for the patients with psychotic disorders**
Chun-Kai Fang (TWN)
- P 320. Preliminary study on the effectiveness of rehabilitation activities in chronic wards in Taiwanese psychiatric centers**
Li-En LIN (TWN)
- P 321. A KAWA Model-Based Group for People with Serious Mental Illness: the Life Narratives and Factors Related to Lifestyle**
Han-Yi HSIAO, Ting KAO, Po-Yen CHEN, Yen-Wen TSENG, Huei-Lan LU (TWN)
- P 322. Exploring the Effectiveness of the Psychiatric Patient 's Participation in Safe Medication Education Practice**
Hsiao-Tan CHIOU, Yen-Chun LIN, Huei-Lan LU (TWN)
- P 323. Establishing the Self-harm Prevention Procedures to Reduce the Self-harm Rate of Psychiatric Inpatients in Southern Taiwan**
Hui-Ling TSAI, Huei-Lan LU (TWN)
- P 324. Applying innovative techniques to enhance psychiatric inpatient bathing completion rate**
Chun-Ti YU, Kuo-Jui CHANG (TWN)

PROGRAM DETAILS

FRIDAY, June 8, 2018

P2.6 Mental health of patients and staff

Venue: Sala Maggiore, second floor

- P 325. Effects of Mandala drawing on Emotion Adjustment and Psychological reaction in Patients with Chronic Mental Illness**
Yu-En SUN, Che-Cheng CHU, Chiou-Yu WU, Wen-Hsiu CHIANG (TWN)
- P 326. Newly employed nursing staff support groups for 10 years**
Yu Mei TSAI, Bao Chen CHEN, Pei Fang CHIA (TWN)
- P 327. Promoting Mindfulness-Based Stress Reduction to Enhance Resilience of Healthcare Workers in the Workplace**
Jung-Hua HSUEH, Hu-Hui FANG, Fang-Tsu LAI, Yi-Ching CHEN, Fu-Jean LIU, Yuan-Tsung TSENG (TWN)
- P 328. Psychometric Comparisons of the QOLIBRI between Individuals with Mild and Moderate/Severe Traumatic Brain Injuries**
Yu-Jun CHANG, Mau-Roung LIN, Wen-Miin LIANG (TWN)
- P 329. The effectiveness of Art therapeutic group on clients with mental illness: a pilot study.**
Yen-Wen TSENG, Po-Yen CHEN, Huei-Lan LU (TWN)
- P 330. Association of Knowledge on Resuscitation Medications and the Stress Perception in Resuscitation Event in Post Graduate Year New Nurses**
Shu-Lin CHEN, Chieh-Fan CHEN, Wen-Ter LA (TWN)
- P 331. The survey to evaluate Happiness of our home medical care.**
Taiga TSUGIMATSU, Fumihito SAITOH, Misato MIKIHARA, Kayo NAGASHIMA, Kazumi SON, Sachie TANAKA, Masami KAWAKAMI, Kyota NEGISHI (JPN)
- P 332. A brief recovery program for patients with mental illness**
Chia-Ying LEE, Shin-Ling LIN, Jin-Shiung CHENG (TWN)
- P 333. Health promotion activities to enhance the physical and psychological health care workers and the life quality impact**
Ling-Wei CHENG, Yu-Ping YIN, Miao-Mei TSAI, Shung-Ti SU, Yu-Ju LI, Hsing-Chi CHUNG, Kang-Pan CHEN, Jin-Shiung CHENG (TWN)
- P 334. The Effectiveness of Relationship-focused Therapy in Suicide Caring Visiting-A Experience of a hospital in Tainan Taiwan**
Yi-Wen LIAN, Fu-Nung HSU, Chen-Pang WANG, Huei-Lan LU (TWN)
- P 335. Using Religious Music as Stress Relief on Patients**
Chiaming YEN (TWN)
- P 336. A study of the correlation between job satisfaction and burnout on the physicians of a Taipei hospital**
Hsin-Yi LIEN, Ming-Chen CHEN, Lin-Chung WOUNG, Jia-Jye CHENG, Kang-I CHAO, Irving Yi-Feng HUANG (TWN)

PROGRAM DETAILS

FRIDAY, June 8, 2018

- P 337. The Relationships Between Insight, Perceived Dignity and Depressive Symptoms in Patients with Chronic Schizophrenia**
Hui Min HSU (TWN)
- P 338. Psychosocial work factors and mental health problems among nurses**
Tiina FREIMANN, Jane FREIMANN, Margarita MILIHHINA (EST)
- P 339. How are over 50s**
Elisabetta SANTIN, Patrizia PORTOLAN (ITA)
- P 340. Employment Satisfaction and Maslow's Hierarchy of Needs then Expansion Theory by the Pastoral Care Department.**
Mariola STAWASZ (TWN)
- P 341. To analysis the impact of the MBSR training for the nursing staffs**
Main-Ling HUANG, Yi-Chia LIN, Wei-Ting WU, Yu-Ping HO, Tung-Yun WU, Sou-Hsin CHIEN (TWN)
- P2. 7 Patient empowerment and involvement**
Venue: Sala Maggiore, second floor
- P 342. Outcomes of Promoting Medical Shared Decision-Making in a Regional Hospital in Taiwan**
Shu-Hui LIN, Shu-Chiao SHEN, Tzu-Chuan HSU, Shu-Mei LIN (TWN)
- P 343. Implementing and promoting an open electronic medical record system in our hospital: empowering patients by encouraging them to check their own charts**
Takako SUGA, Toh Yoon Ezekiel WONG, Junko TATEISHI, Hirohiko MURATA (JPN)
- P 344. Offering Integrated Breast Care Services for Women – A Community Hospital Experience**
Chin-Hung TSAI, Yi Tsen TSAI, Hsiu Feng KUO, Xiao-Lian ZHUO, Chia-Herng YUE (TWN)
- P 345. Using Bruner's Theories on Learning to improve foreign caregivers cognitive of prevention inpatient falls at rehabilitation ward**
Shu-Ping HUNG, Chun-Chen HSU, Hui-Yui PAI, Sung-Yun CHEN, Yi-Fan TSAI (TWN)
- P 346. The effect of nursing instruction for patients to demonstrate well wound care by themselves before discharging from hospital.**
Shu-Chun WU, Fu-Lian CHUANG, Jin-Shiung CHENG (TWN)
- P 347. Implement new education material to empower caregivers and decrease the adverse events**
Hsiao-Fang HUANG, Li-Chin CHEN, Yu-Tzu LI, Szu-Fen HUANG, Hsiu-Yun LIU, Jui-Sheng SUN (TWN)
- P 348. Shared decision making to support home care patient before end of life**
Hsin-Yi LIEN, Ming-Chen CHEN, Wen-Jung SUN, Lin-Chung WOUNG, Sheng-Jean HUANG (TWN)
- P 349. LIC Donna project: take care for yourself beyond cancer illness**
Giulia RUBINI, Rosalba PALERMO, Silvia DI LEO, Martino ABRATE, Ermanno RONDINI,

PROGRAM DETAILS

FRIDAY, June 8, 2018

Lucia MANGONE, Elisa RABITTI, Guglielmo FERRARI, Francesca ZIRONI,
Massimo COSTANTINI (ITA)

P 350. Inviting Patients to Read Their Doctors' Notes in a Pain Clinic: Physicians' Experiences
Ashish BHANDARI, Christopher GILLIGAN, Ji Hong LEE, Manasi BHANDARKAR,
Victor WANG (USA)

P 351. The establishment of Shared Decision Making & Patient Decision Aids Does it meet the needs of patients and their families? Take Taiwan as an example
Chen Yi-HSUAN, Pei-Jung YU, Ju-Chies HUANG, Chiu-Feng WU, Willi-Am SU,
Ru-Jie HUANG (TWN)

P 352. Improving the Quality of Patients' Care by Using the Patient Decision Aid of Shared Decision-Making
Fu-Lien CHUANG, Shu-Ling WANG, Li-Hua LIN, Yi-Chen TANG, Jin-Shiung CHENG (TWN)

P 353. Transforming Practitioners and Practice through Work-based Learning
Frances FINN (IRE)

P2.8 Physical activity promotion
Venue: Sala Maggiore, second floor

P 354. The Effects of Health Promotion Activities on Body and Mind in the aging population
Pei-Ching LIN, Ren-Huai CHANG, Ya-Ai CHENG, Hsiu-O HUANG (TWN)

P 355. Prevention of Social Isolation in Community ~Introducing a Square Step Exercise~
Aoi TAKAGI, Shohei SUZUKI, Nobuyuki MISHIMA, Yusuke OKUZONO, Naoki SAWADA,
Nariaki MORIKAWA, Kazuyuki NARITA, Shinichi TSUJIGUCHI, Kana KURODA,
Yu NAKAJIMA, Yoshie YUKI (JPN)

P 356. The Effects of Early Whole-Body Vibration Training for Rehabilitation After total knee arthroplasty (TKA)
Yi-Chueh TSAI, Wei-Lin LIU, Shih-Feng LIN, Hsuan-Ti HUANG, Tien-Wen CHEN,
Jia-Xin CHEN (TWN)

P 357. Effectiveness of Core Muscle Intervention Program for Musculoskeletal Disordered Workers in a Medical Center
Hui-Ping CHIU, Pei-Shan TSAI, Hsienjy-Jy MA (TWN)

P 358. Cost-performance Value between Corporate Allowances and Employees' Exercise Frequency - Pilot Study
Chih-Ming CHANG, Chia-Chi YEN (TWN)

P 359. Experience of sharing special population successful physical activity promotion--Longci Home for the Disabled in Taiwan as an example
Bie-Ching LIU, Mei-Hui WU, Hsiu-Hua LEE, Ge-Lin CHIU, Yu-Wen CHEN (TWN)

P 360. Effectiveness evaluation of the Health Promotion Program in Baduanjin Qigong Practice
Chin-Chuan TSAI, Ya-Ai CHENG, Jung-Sheng YU, Yuan-Ho LIN, Wan-Jung LIN,
Wei-Chen CHOU, Kuan-Tso CHEN, Pei-Ching LIN (CHN)

PROGRAM DETAILS

FRIDAY, June 8, 2018

P 361. Physical activity on prescription with counsellor support: a 4-year registry-based study in routine health care in Sweden

Pia ANDERSEN, Sara HOLMBERG, Lena LENDAHL, Per NILSEN, Margareta KRISTENSON (SWE)

P 362. Application “Happy GO” Program to Improve the physical activity in Pediatric Oncology Inpatients

Fang-Ru LIN, Ping-Ying HSU, Mei-Chi FANG (TWN)

P2.9 Promoting health by ICTs and telehealth programs

Venue: Sala Maggiore, second floor

P 363. Relationship between physical activity and obesity: A smartphone-based intervention

Bumjo OH, Yun Hwan OH, Chang Hee LEE (KOR)

P 364. The Feasibility, Baseline Patient Characters and Clinical Utilization of Integrated Telemedicine as New Primary Care Model in Chronic Heart Failure in Current Era

Ying-Ju CHEN, Chung-Lieh HUNG, Wen-Ling CHANG, Shu-Hsiu KO, Jui-Peng TSAI, Kuo-Tzu SUNG (TWN)

P 365. Effectiveness of “Applying Multi Media materials handover in nursing shift changing” for the training of new nursing staff

Ya-Lin SHEN, Shu-Chin CHEN (TWN)

P 366. A Patient-centered Interprofessional Collaboration Computerized Platform

Chia-Jung CHEN, Chung-Feng LIU, Jing-Jia LIN, Tzu-Lan LIU (TWN)

P 367. A Study on the Benefits and Satisfaction of the Electronic Official Document On-line Submission and Approval System - A Case Study of a Medical Center in Southern Taiwan

Lin Kun WU, Shih Yu CHEN, Chia Mei HSIA, Hsiu We HUNG, Yi Chen WU (TWN)

P 368. Assessing factors impacting the quality of a hospital-based telecare and telehealth service

Feng-Yueh YANG, Por Lai, Yen-Hung KUO, Feng-Nien YANG (TWN)

P 369. The research about the service quality of registering by an operator via telephone affects people's decisions to seek medical care

Jia-Chen SU, Kun-Yi LIU (TWN)

P 370. Personalized Preventive Healthcare Information Cloud Services in Taiwan

Chia-Hui LEE, Hao-Yuan TING, Te-Hsun CHIU, Shih-Min CHIANG, Shu-Li CHIA (TWN)

P 371. To improve the effects of medical education for inpatient and their families by utilizing QR-Code sound and vision system

Wan-Zhen YANG, Chi-Chen HSU, Fang-Ying CHIANG, Tung-Yun WU, Shu-Ting CHUANG, Sou-Hsin CHIEN (TWN)

P 372. Information technology applications remind cardiovascular therapeutics are used in AMI Patients to Increase survival rates

Li-Chin CHEN, Hsiao-Fang HUANG, Ying-Hsien CHEN, Yih-Shang CHEN, Ching-Yaw SUN, Jih-Shuin JERNG, Szu-Fen HUANG, Jui-Sheng SUN (TWN)

PROGRAM DETAILS

FRIDAY, June 8, 2018

- P 373. The Effects of Computerized Cognitive Training in Individuals with Stroke: A Single-Blind, Randomized Controlled Trial**
Hsiu-Yu HO, Ming-De CHEN (TWN)
- P 374. The Implementation of Electronic Form of Clinical Pathway**
Chia-Kuei LIN, Yu-Tzu LI, Szu-Fen HUANG, Li-Chin CHEN, Ya-Ting HSU, Jui-Sheng SUN (TWN)
- P 375. National Health Insurance electronic referral platform system**
Chih Ya YANG, Pei Chen YANG, Ying Hui CHEN, Wan Ling CHEN, Yi-Lien LIU (TWN)
- P 376. Exploring the continuity of telehealthcare: the experience from a medical system in southern Taiwan**
Yen-Hung KUO, Rhay-Hung WENG, Ling-Sui CHEN, Shu-YU YEN, Ssu-Yen LIN (TWN)
- P 377. Feasibility of a novel tele-eye care protocol for ocular diseases detection among the disabled in the community settings**
Lin-Chung WOUNG, Ching-Yao TSAI, I-Lun TSAI, Chung-Sen CHEN, Hui-Chuan CHUNG (TWN)
- P 378. Improving the Teaching Ability of Clinical Teachers on Making Teaching Materials: Using 3C Technology as an Example**
Li-Chen CHANG, Dai-Ni LI, Hsin-Yi YANG (TWN)
- P 379. Patient-centered automation system for cerebrovascular accident database**
Hsuan-Yu WANG, Kang-I CHAO, Lin-Chung WOUNG, Yin-Zhuang HUANG, Yu-Yi YEH, Shih-Hsin HSU, Hung-Lieh CHOU (TWN)
- P 380. The smart phone-modified health education mode**
Yi-Lien LEE, Ya-Han HU (TWN)
- P 381. A Research of Information System Implementation on Regulating the Prescription of Controlled Drugs- Case Study in a Regional Hospital in North Taiwan**
Ling-May LI, Yu-Wen LIN, Nan-Ping YANG, Ching-Feng LIN (TWN)
- P 382. Development of a mobile application for tailored health behavior intervention to manage metabolic syndrome**
Jiwan KANG, Jiye KIM, Harim KIM, Juyeon KO, Yuri KIM, Kwangsuk KO, Minsoo LEE, Hyekyeong KIM (KOR)
- P2.10 Reorienting health services**
Venue: Sala Maggiore, second floor
- P 383. The Relationships among Perceived Risk, Brand Trust, Herd behavior and Help-seeking intention: The Case of A Hospital in Taiwan.**
Yi-Hsuan LIN (TWN)
- P 384. From female viewpoint to construct female-friendly medical environment**
Zi-Zhen FU, Chun-Huang LAI, Chi-Cheng HUANG, Jin-Yun CHEN, Feng-Qing SUN, Wei-Qing SUN, Wen-De LAI (TWN)

PROGRAM DETAILS

FRIDAY, June 8, 2018

- P 385. Apply the Strategy of Propaganda By Walking Around to Enhance Staff's Awareness of Health Promotion Policy in Changhua Christian Hospital**
Pei-Jyun CHEN, Pei-Ju HUANG, Yu-Ting NIEN, Yi-Fang TSAI, Li-Ya CHEN, I-Ling HUANG (TWN)
- P 386. The comprehensive effort to apply health promotion concepts across all areas of the first citizen-initiated public hospital to be opened in 2019: the project report of HPH Task Force Team of Seongnam Citizens Medical Center**
Misook AHN, Inja KIM, Yongju SHIN, Sungil JI, Taebong JUNG, Jeongwon LEE (KOR)
- P 387. Supporting good hospital climate**
Marie VLACHOVÁ, Jana NOVÁKOVÁ, Klára POLÁŠKOVÁ (CZE)
- P 388. Project "Visitare": Promoting quality and safety in health care through professionals' involvement**
Stefano MASTRANGELO, Francesco VERCILLI, Erica BACCARANI, Roberto CAROLI, Dorella COSTI, Cinzia GENTILE, Rossana MARMONTI, Vilma ZAMBONELLI (ITA)
- P 389. The Optimization Strategies to Promote The Hospital-based Cancer Screen**
Yi-Hung LIAO, Lu-Yin HSU, Dian-Kun LI, Chao-Chen HUNG, Ching-Hsuan LO, Shou-Hsin CHIEN (TWN)
- P 390. Analysis on the Change of Complaint Pipelines used by Patients: Taking a Regional Hospital in Southern Taiwan as an Example**
Chih Yuan JAO, Li-Chen CHANG, Wu-Pin LIN, Hsin-Yi YANG, Solomon Chih-Cheng CHEN (TWN)
- P 391. Integration of health and welfare promotion into home care for older people and informal care in all age groups**
Arja HYYTIÄ, Soili ALANNE, Matti REKIARO, Anneli SAARINEN (FIN)
- P 392. Employment rate and predictors of return to work in European cancer survivors: a systematic review**
Stefania COSTI, Sara PALTRINIERI, Stefania FUGAZZARO, Lucia BERTOZZI, Chiara BASSI, Martina PELLEGRINI, Massimo VICENTINI, Elisa MAZZINI (ITA)
- P2.11 Promoting a tobacco free environment**
Venue: Sala Maggiore, second floor
- P 393. The short-term success rate of smoking cessation at 3 months post discharge**
Yi-Lien LIU, Chin-Hishin WEN, Pei Chen YANG, Wan-Ling CHEN, Yi -Tin CHEN (TWN)
- P 394. World No Tobacco Day**
Hui Wern KHAW, Teik Kee NG, Ya Hui LEW (MYS)
- P 395. Action stop smoking clinics**
Hsin-Lung CHAN, Wang-Hsin KAO, Wei-Hsin HWANG, I-Jung LU, Ta-Chuan HUNG (TWN)
- P 396. How hospital counsel school to promote prevention of tobacco-hazard in health impetus mode**
Chun-Huang LAI, Chi-Cheng HUANG, Feng- Qing SUN, Wei Chun HSUEH, Shu Ling LIN, Zi Zhen FU (TWN)

PROGRAM DETAILS

FRIDAY, June 8, 2018

P 397. Quality Improvement of Smoking Prevention Class! Organizational Changes in Hospital, Multi-professional Collaboration in Community, And Utilization of Social Capital
Sayo OTANI, Ai NOGUCHI, Shotaro IMAMURA, Miho MAEDA, Yoshie YUUKI (JPN)

P 398. Promoting Smoke-free Hospital Service in Taiwan
Fang-Lun CHANG, Yi-Jiun CHOU (TWN)

P 399. Result of Creative Anti-smoking Health Education in the Smoke-free Hospital
Mei-Yen CHANG, Chia-Jung TSAI, Chiu-Hsia YU, Chia-Chi YEN (TWN)

P 400. Smoke-free hospital quality service enhancement program
Shih-Chen YANG, Chia-Yi KUO, Hui-Hua TSAI (TWN)

P 401. The smoking ban in the hospital structures of the Pavia ASST
Elisa SOTTOTETTI , Gian Carlo SCARPINI , Carluccio TORTI (ITA)

P 402. Applying KAWA model to promote teenager tobacco control in campus
Wei-Ju WANG, Pei-Chi SU, Yu-Tai LO, Wen-Chin LIOU, Yi-Hua YANG (TWN)

P2.12 Tobacco cessation
Venue: Sala Maggiore, second floor

P 403. Evidence-Based Smoking Cessation Practices of Health Promoting Hospitals for Korean Soldiers
Eunjoo KWON, Eun-Hee NAH, Seon CHO, Young-Jae SHIN, Pil-Su KANG, Jun-Won JEONG, Saehee HAN (KOR)

P 404. Promoting the implantation of intensive smoking cessation counseling program in hospitalized patients
Chun-Ying LEE, Chiou-Mei LEE, Bo-Cheng HUANG (TWN)

P 405. Effect of smoking cessation with acute myocardial infarction on reducing rate of recurrent significant stenosis of coronary artery Experience in North Taiwan
Chia-Wen LEE (TWN)

P 406. The Research on Smoking Behavior, Anti-smoking Attitude and Anti-smoking Self-efficacy of Teenage Smoking Cessation Students
Yi-Fen HU, Chien-Chi CHOU, Wen-Ho HUANG, Yuan-Tsung TSENG (TWN)

P 407. Smoking Cessation with Non-pharmacological Counselling in Inpatients Admitted with Acute Coronary Syndrome
Chung-Hung TSAI, Min-Fu WANG, Shou-Cheng HUANG (TWN)

P 408. Use of bonuses to reward employees to enhance the effectiveness of smoking cessation
Yen-Tze LIU, Pei-Jyun CHEN, Yu-Ting NIEN, I-Ling HUANG, Yi-Fang TSAI, Li-Ya CHEN, Yu-Wen YANG, I-Ching LIN (TWN)

P 409. Increase the Effectiveness of Smoking Cessation with Creative Health Education
Mei-Yu WU, Ching-Mei TSAI (TWN)

PROGRAM DETAILS

FRIDAY, June 8, 2018

- P 410. Do you want to quit smoking? We will support you.**
Marie VLACHOVÁ, Soňa CSEMYOVÁ, Klára POLÁŠKOVÁ (CZE)
- P 411. The combination of medication and behavioral counseling improves the cessation rate in Taiwan**
Ying-Wei WANG, Gobin HUANG, Chen-Han CHUEH, Yi-Hua CHIN, Shu-Ying LO, Li-Hui YU (TWN)
- P 412. Analysis of the results among chronic disease and pregnant woman tobacco control**
Ying-Hua SHIEH, Li-Chuan CHEN, Chung-Ying LU, Hsiung-Fei CHIEN (TWN)
- P 413. Experience of Delivering Smoking Cessation Clinic Accompanied with Health Promotion Activities**
Min-Fu WANG, Shou-Cheng HUANG, Li-Yu CHEN, Chung-Hung TSAI (TWN)
- P 414. The Improvement Program of Enhancing the Acceptance Rate of Smoking Cessation Health Education on Cardiology Outpatients**
Huei-Min CHEN, Peir Dan MO (TWN)
- P 415. Effectiveness of behavior interventions in adolescent smoking cessation**
Tzu-Ying YU, Meng-Fen CHIEN, Yi-Chi HSU, Tsung-Huai KUO, Ai-Wei SHIH (TWN)
- P 416. Effectiveness of a 6-week school-based smoking cessation program in a senior high school**
Chiou-Mei LEE, Chun-Ying LEE, Bo-Cheng HUANG (TWN)
- P 417. The effect of Giving up cigarette from hospital team at workplace**
Hui-Chuan HUANG (TWN)
- P 418. The study of five protection section promote tobacco cessation environment**
Yao-Yi ZHUYIN, Ling-Ling CHOU, Shih-Shiung WU, Guang-Jin SHIUE, Jin-Shiung CHENG (TWN)
- P 419. Repeated treatment of tobacco dependence: 12 months abstinence rates**
Lenka STEPANKOVA, Eva KRALIKOVA, Kamila ZVOLSKA, Alexandra PANKOVA, Zuzana ADAMCEKOVA (CZE)
- P 420. Effectiveness of a smoking cessation intervention in preoperative anesthetic inpatients**
Chin-Fang Chang, Su-Fen Cheng, Chia-Yu Wu, Jui-Lan Hung, Kuang-Chieh Hsueh, Meei-Jyhi Huang, Jin-Shiung CHENG (TWN)
- P 421. Medical professionals provide brief advice on the effectiveness of health education**
Chia-Yu WU, Su-Fen CHENG, Meei-Jyhi HUANG, Kuang-Chieh HSUEH, Jin-Shiung CHENG (TWN)
- P 422. Tobacco cessation – as we want it! An interview study with young people.**
Ingrid EDVARDSSON AURIN (SWE)
- P2.13 Staff training and education to improve health**
Venue: Sala Maggiore, second floor

PROGRAM DETAILS

FRIDAY, June 8, 2018

- P 423. Factors affecting hospital physicians' Performances- Take a municipal hospital as an example**
WeiTing CHENG (TWN)
- P 424. The Outset research on the Job Course Model for Nurses in Public Health Institutions in Korea**
Dongwon LEE, Insuk YANG (KOR)
- P 425. Reducing the Incidence and Injury Rate of Falls in Gastroenterology Ward by Means of an Interdisciplinary Quality Improvement Project**
Yu-Lan LIEN, Truey-Yeh SONG (TWN)
- P 426. Project to Enhance the Integration of In-hospital Resuscitation in a Ward**
Zih-Jhen FU, Bo-Syun LIN, Wen-Ter LA, Shu-Lin CHEN (TWN)
- P 427. Preliminary Study of Using the Simple Operation Cards with Mnemonic Phrases to Improve Learning Effectiveness among Newly Employed Registered Nurses for Operating Noninvasive Ventilators**
Wen-Chuan LU, Li-Ling HSU, Sung-Yun CHEN, Yi-Fan TSAI (TWN)
- P 428. The "Osservare" Project: Engaging health professionals to improve the safety surgery check list implementation**
Stefano MASTRANGELO, Francesco VERCILLI, Francesco SONCINI (ITA)
- P 429. A pilot study to evaluate the efficacy of reducing legs edema of bed ridden inpatients by use of elastic bandage and stocking**
Yu-Shan JANE, Sung-Yun CHEN, Lan-Fang HSIAO, Yi-Fan TSAI (TWN)
- P 430. The Analysis of 72- hour return visits risk factors to pediatrics emergency department in Taiwan**
Shu-Lin CHEN, Chieh-Fan CHEN, Wen-Ter LAI (TWN)
- P 431. Study of the cognition, attitude and behavior of the nursing staff and the supervisors toward the infection control of LTCFs**
Shu-Ting CHUANG, Mei-Fang CHANG, Shu-Fang TSAI, Yu-Ping HO, Sou-Hsin CHIEN (TWN)
- P 432. A Probe into the Correlation between Medicine Simplification and Enhancement of Inpatients' Medicine Knowledge**
Shiou-Jin YANG, Pei-Shan LI, Huei-Lan LU, Ching-Ming CHENG (TWN)
- P 433. Experience of Team Resource Management Model in Blood Transfusion Safety**
Chi-Chao TU, Pei-Ning LEE, Tung-Huan WU, Meng-Ting WU, Yu-Wen LIN, Nan-Ping YANG, Ching-Feng LIN (TWN)
- P 434. Designing Instructional Scaffoldings for New Nurses Self-Regulated Learning Task-Based Situational Awareness Modular Curriculum on In-Patient Resuscitation and Care**
Chun-Chao HUANG, Man-Ying Fang HSU (TWN)
- P 435. Applying Team Resource Management Model to Reduce the Rate of Patient Fall Incident in Psychiatric Acute Ward**
Shu-Fen TASI, Hsiao-Tan CHIU, Shu-Min CHANG, Huei-Lan LU (TWN)

PROGRAM DETAILS

FRIDAY, June 8, 2018

P 436. Chronic ward urinary tract infection improvement program by community hospital-Taiwan experience

Kuei Hua YEN, Jui Feng CHANG, Jia Wen HUANG , Li Chueh KAO (TWN)

P 437. Analysis of people's behavior pattern of drug concept

Ju-Fang WU, Chen-Ying SU, Po-Chuen SHIEH, Wen-De LAI (TWN)

P2.14 Miscellaneous

Venue: Sala Maggiore, second floor

P 438. International conference – Development of health promoting activities and quality of care in healthcare facilities

Veronika STEJSKALOVÁ, Milena KALVACHOVÁ (CZE)

P 439. Shorten Picking Material Work Time at Regional Hospital Central Storage

Chiung Fen LIU, Fang Chi CHEN (TWN)

P 440. Using PDCA procedure to improve inpatient completion rate of examination in neuro-electrical examination room

Hui-Ju CHEN, Chiou-Lian LAI , Chun-Hung CHEN, I-Fang HUANG, Po-Ying HUANG (TWN)

P 441. The Effectiveness of Implementation of Betel Nut Cessation Strategies – A Single Center Experience

Chin-Hung TSAI, Yi Tsen TSAI, Hsin Yi KUO, Mei-Huei LI, Hsiu Feng KUO (TWN)

P 442. Using SDM to improve the rate to accept tracheotomy for those ICU patients who are prolonged mechanical ventilation-dependent (PMV)

Yu-Ping HO, Pei-Chi HSIEH, Huan-Ting SHEN, Shu-Ting CHUANG, Sou-Hsin CHIEN (TWN)

P 443. The research of Patients Satisfaction at a Emergency Department in Southern Taiwan

Jin-Ming SU, Chieh-Fan CHEN, Wen-Ter LAI , Shu-Lin CHEN (TWN)

P 444. Reduce the duration of ICU transfer delay

Ya-Fen KUO, Cha-Ying SUE (TWN)

P 445. Enhance the Efficiency and Satisfaction of Material Management by Using 5S and Ergonomics

Hsin-Yi LU, Shu-Chuan CHEN, Chiou-Yu WU, Ia-Ling CHEN (TWN)

P 446. Achievements from and future challenges to attending International HPH Conference - Analysis of presentation titles and plenary themes over the last 6 years (J-HPH Network)

Norihiko HATA, Mitsuhiko FUNAKOSHI, Kyota NEGISHI, Masahiro ITO, kazuhiko OGATA, Norio SHIMANOUCHI (JPN)

P 447. Patient-centered Coordinated Health Care Services Integrating Chinese Herb Medicine into Weight Management Program - Experiences in a Community Hospital in Taiwan

Yi-Wen TSAI, Yiu-Hua CHENG, Mei-Wen WANG, Shih-Han LAI, Yi-Chuan CHEN, Chien-Tzung CHEN (TWN)

PROGRAM DETAILS

FRIDAY, June 8, 2018

- P 448. Research on the Relationship between Nursing Staff's Performance and Patient Satisfaction**
Ya-Ling LI, Meng-Chuan TSAI, Ai-Wei SHIH (TWN)
- P 449. The experience in utilization of portable ultrasonography for urological conditions in a home care setting**
Ming-Chung KO, Sheng-Jean HUANG, Yi-Chun CHIU, Lin-Chung WOUNG (TWN)
- P 450. Norwegian Healthy Life Centers - an overview of results from studies on participant characteristics and health outcomes**
Turid SUNDAR, Inger Merete SKARPAAS (NOR)
- P 451. Analysis on the behavior pattern of people's choice of drugs**
Ju-Fang WU, Chen-Ying SU, Po-Chuen SHIEH, Wen-De LAI (TWN)
- P 452. What Role Do Hospital Play for People with Disabilities: Patient-Centered Care Perspective**
Tzu-Hui HUANG, Hsiu-Chu CHIANG, Tien-Sheng TSAI, Kuo-Hsing LIN (TWN)
- P 453. A policy to cooperate with the government to provide athletes with integrated medical care combining health service and health promotion**
Pei-Hsuan LEE, Ming-Gu ZHONG (TWN)

MAPS OF CONFERENCE VENUE



Piano Terra - Lower Ground Floor

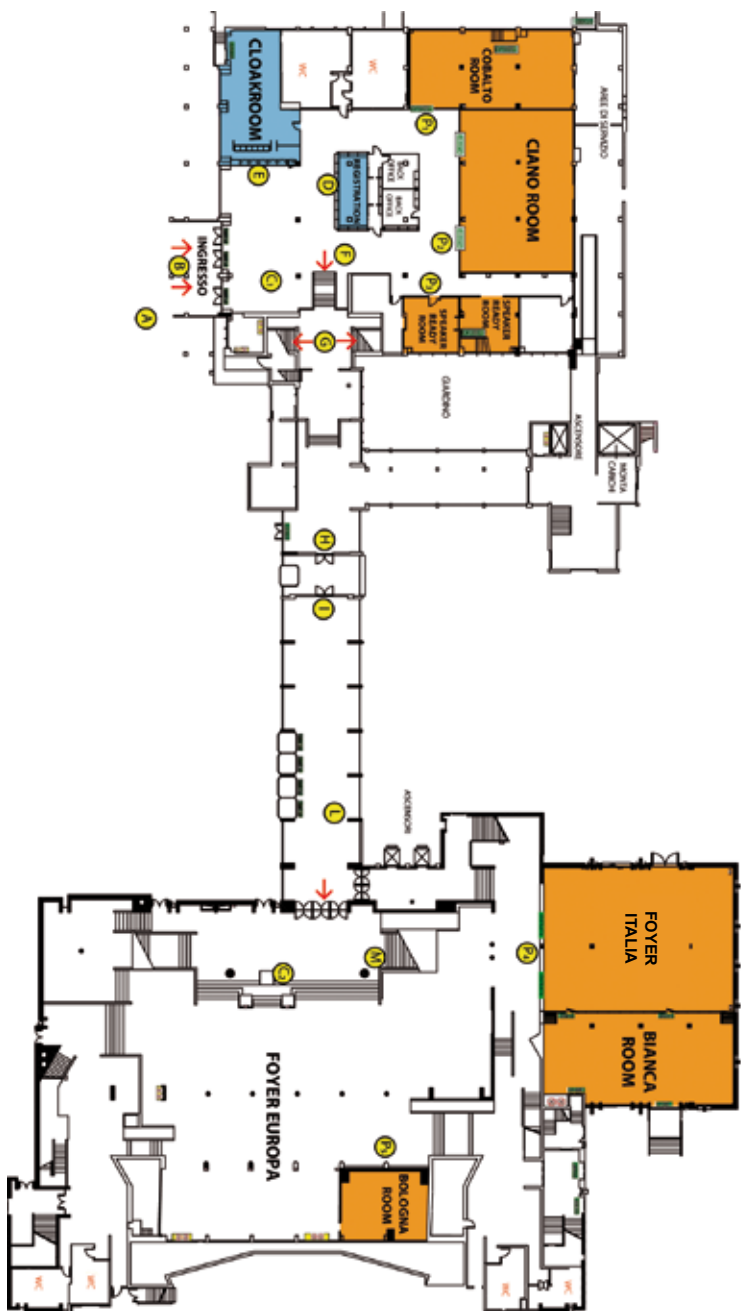

Primo Piano - First Floor



Sala Maggiore

First Floor

Palazzo della cultura e dei congressi

Secondo Piano - Second Floor

Sala Maggiore - Second floor



NOTES

26TH International Conference on Health Promoting Hospitals and Health Services

June 6-8, 2018 – Bologna, Italy

Health promotion strategies to achieve reorientation
of health services: evidence-based policies and practices



Local Organizer



SERVIZIO SANITARIO REGIONALE
EMILIA-ROMAGNA
Azienda Unità Sanitaria Locale di Reggio Emilia
IRCCS Istituto in tecnologie avanzate e modelli assistenziali in oncologia

Under the auspices of



ISTITUTO
SUPERIORE
DI SANITÀ



Università
degli Studi
di Ferrara